

**KSI**™

ARCHITECTURAL HARDWARE

Quality, Trust and Strength



PRODUCT CATALOGUE



## About Us

KYLO has established as a well-known brand in Glass Architectural Hardware. We thank our pride customers who had supported us in serving their valued needs. We provide complete solutions to our esteemed customers supported with attractive and vast range of designs, elegance, quality, service and last but not the least is fair price.

We offer customer's specific designs suits their requirements. We always look for uniqueness and elegance while developing Glass Architectural Hardware without affecting its convenience, durability and overall quality parameters. Our well-experienced R&D team is relentlessly committed to create innovative designs with cutting-edge technology.

All our activities revolve around quality. We have invested heavily in our team and maintaining products at par with International standards. Quality is a forefront of all our activities – starting from selection of raw materials, streamlining processes and quality-control.

Last but not least is our customer service. All our activities are focused on our customers. In a modern-day competition environment, quick customer response is a key to success of any organization. We work towards this approach to delight our customers.

In a nutshell – behind our success is

Quality – Innovation – Wide Range – Fair Price – Quick Response Time

This is what is required to build a successful brand and KYLO is proud to inculcate this philosophy successfully.

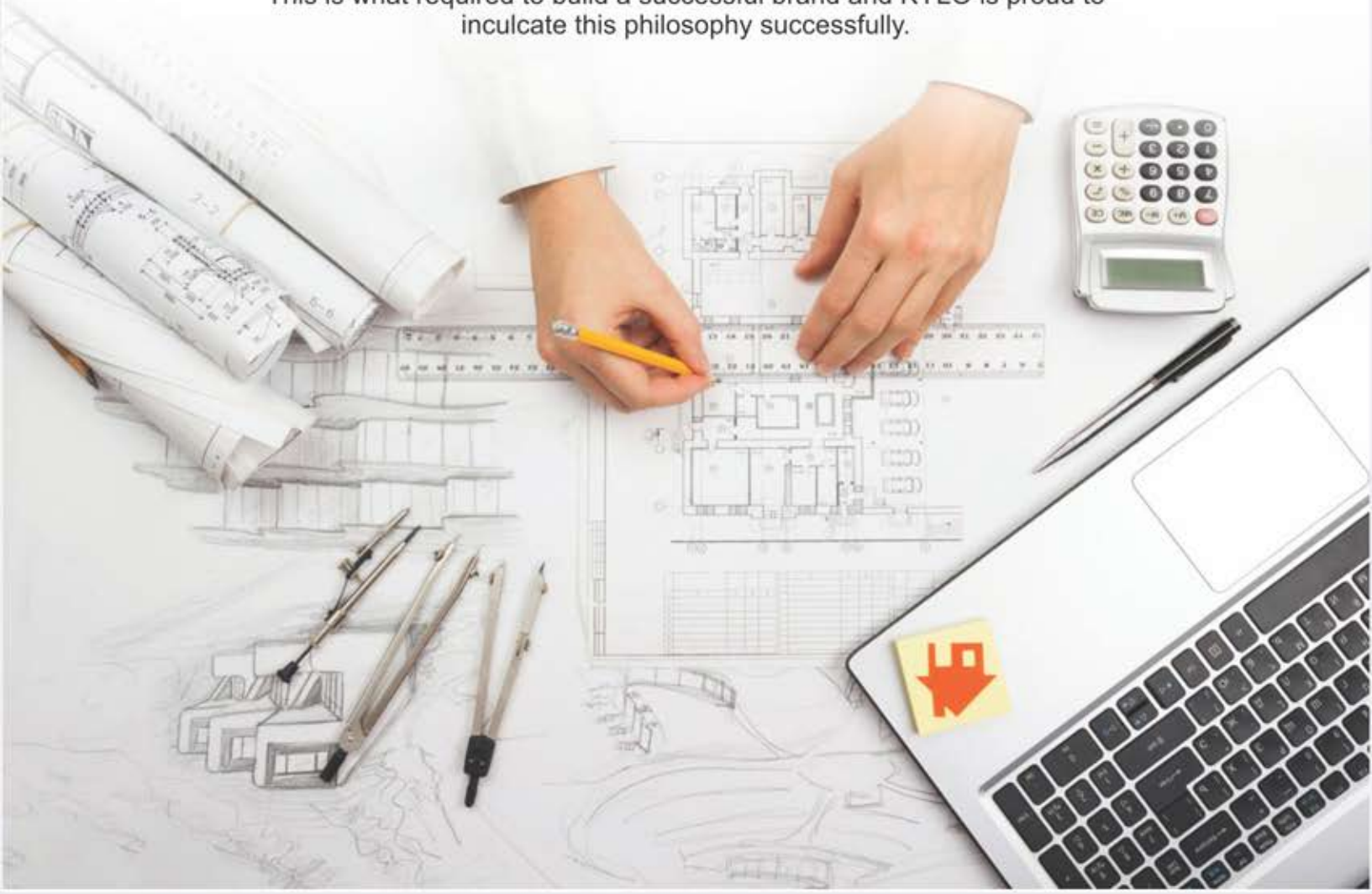



**Kylo™**  
ARCHITECTURAL HARDWARE

**QUALITY TRUST  
AND STRENGTH**



## CONTENTS

Floor Spring	01-02
Hydraulic Patch	03
Patch Fitting	04-08
Premium Series	09-10
Shower Hinges	11-12
Glass Connectors	13-14
Shower Knight Head Acc.	15
Plastic Profiles	16
Reinforcing Bars & Shower Door Knobs	16
Office Sliding System	17-18
Sliding Door System	19-20
Shower Sliding System	21
Canopy Fitting	22
Sliding Folding System	23
Center Sliding Folding System	24
Automatic Sliding Sensor Door System	25
Spider Fitting	26-30
Door Handles	31-34
Locks without Cutout	35
Door Closer	36
Glazing Profile	37
Glass Railing Accessories	38-40

**Construction & Technical Details**

- One unit for both single & double action door where surface mounted closer cannot be fitted.
- High grade cast iron mechanism body is housed within a galvanized steel loose box which is zinc protected & painted for corrosion resistance.
- Internal mechanism components utilizing heat treated high alloy steels & ball bearing for optimum efficiency.
- Suitable for timber, metal & tempered glass doors.
- Built in pressure relief valve protect the closer from rough use. Closer mechanism totally immerse in hydraulic fluid.

# FLOOR HINGE

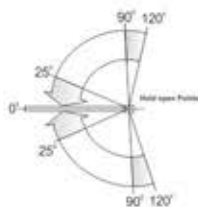
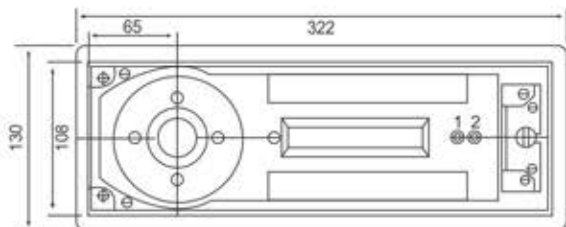

Tested to 500000 Cycles



General design, suitable for left or right hand to open the door in single and both sides.  
 Used low temp. hydraulic oil for any climate operation and constant lubrication.  
 Suitable for wooden and toughened glass doors.  
 Suitable for door weight from 90-120kgs.  
 Closing force 25nm.  
 Suitable for maximum door Width 900x1200mm.  
 Opening angle 90° / 115°

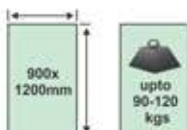

**KFS-8400**  
Double Spring Floor Hinge

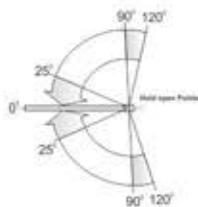
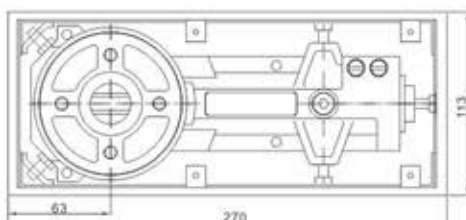

Tested to 500000 Cycles



General design, suitable for left or right hand to open the door in single and both sides.  
 Used low temp. hydraulic oil for any climate operation and constant lubrication.  
 Suitable for wooden and toughened glass doors.  
 Suitable for door weight from 70-90kgs.  
 Closing force 19nm.  
 Suitable for maximum door Width upto 900mm.  
 Opening angle 90° / 115°

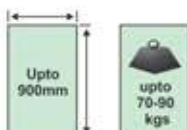

**KFS-6600**  
Single Spring Floor Hinge

Also Available in Premium Series



Tested to 1000000 Cycles

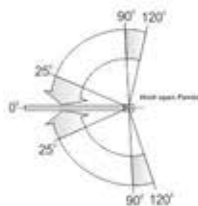
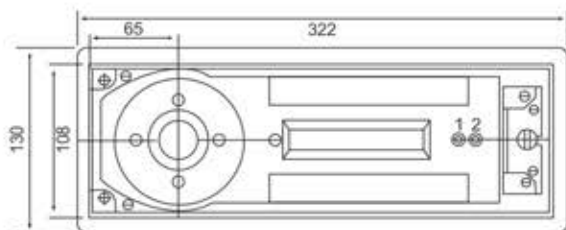

**Specification**

- General design, suitable for left or right hand to open the door in single and both sides.
- Used low temp. hydraulic oil for any climate operation and constant lubrication.
- Suitable for wooden and toughened glass doors.
- Suitable for door weight from 90-120kgs.
- Closing force 25nm.
- Suitable for maximum wide door leaf (900x1200mm).
- Opening angle 90° / 115°

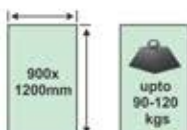

**KFS-8400-S**  
Double Spring Floor Hinge



**KCFS-100**  
Hydraulic Floor Hinge



**KPF-02-BCP**  
Top Patch with Big Cover Plate

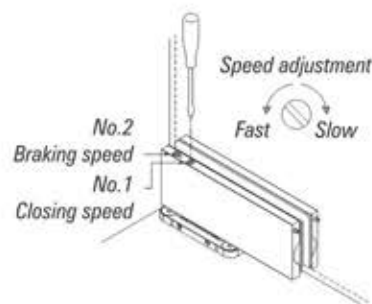

**Product Specification**

- Suitable door weight : Max 90kg
- Suitable door width : 750-900mm
- Suitable door height : 2100-2250mm
- Suitable door thickness : 8-12mm
- Ambient temperature : -20°C~+50°C
- Quick and easy installation
- Max. opening angle: 150° for left and right opening (double action)
- Hold open at 90°
- Two speed adjustment
- Closing Speed (150° ~ 10°)
- Braking speed (10° ~ 0°)

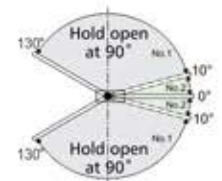
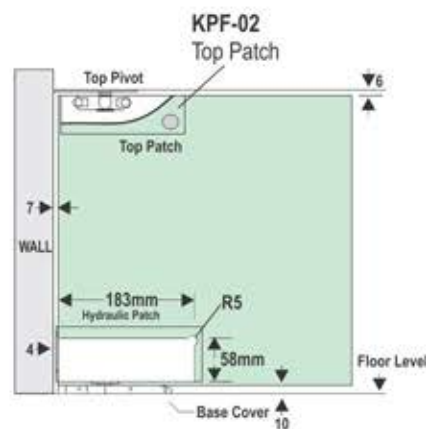

Hold open at 90°



Max. opening 150°  
for left or right hand opening



Max. opening 150°

# PATCH FITTINGS

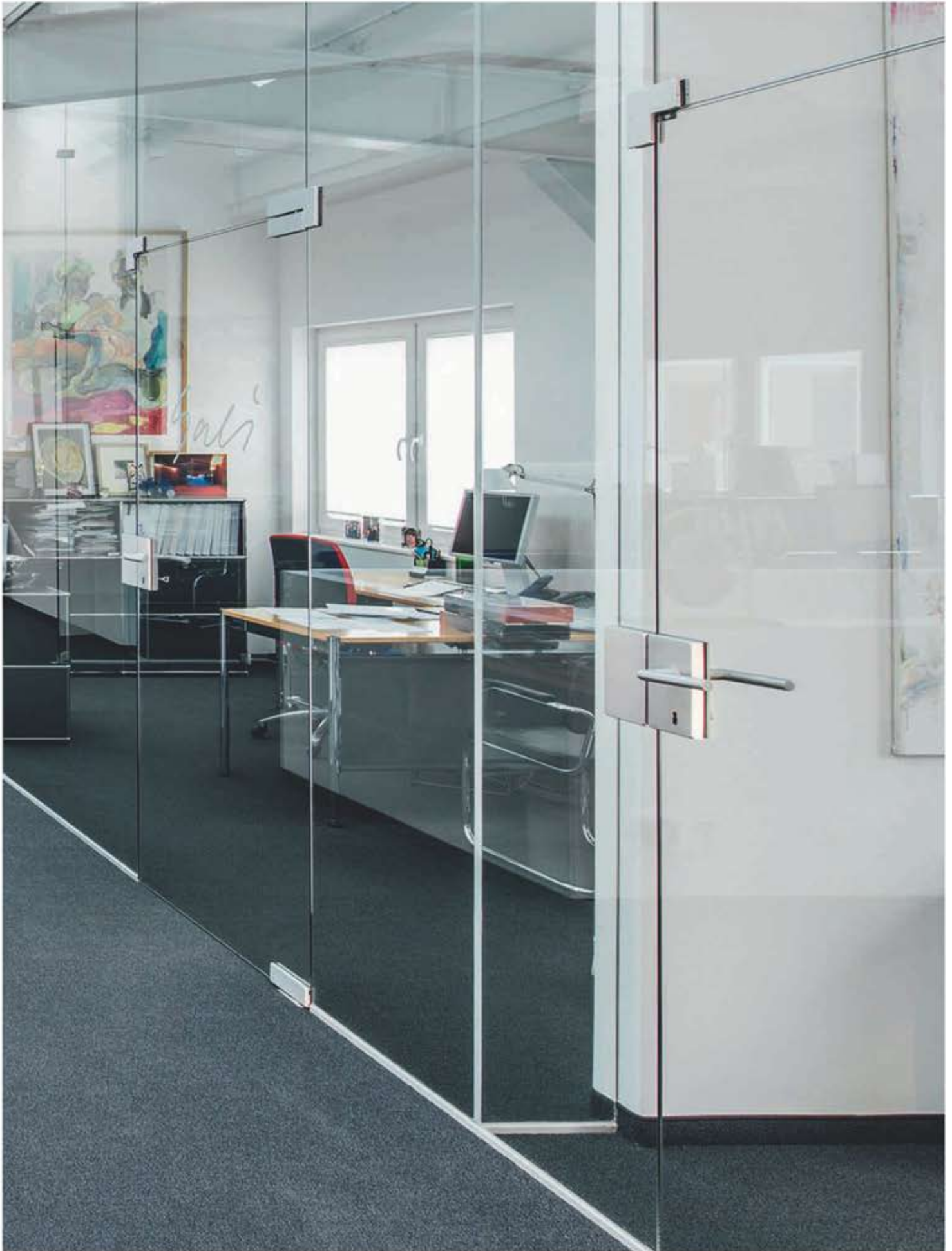

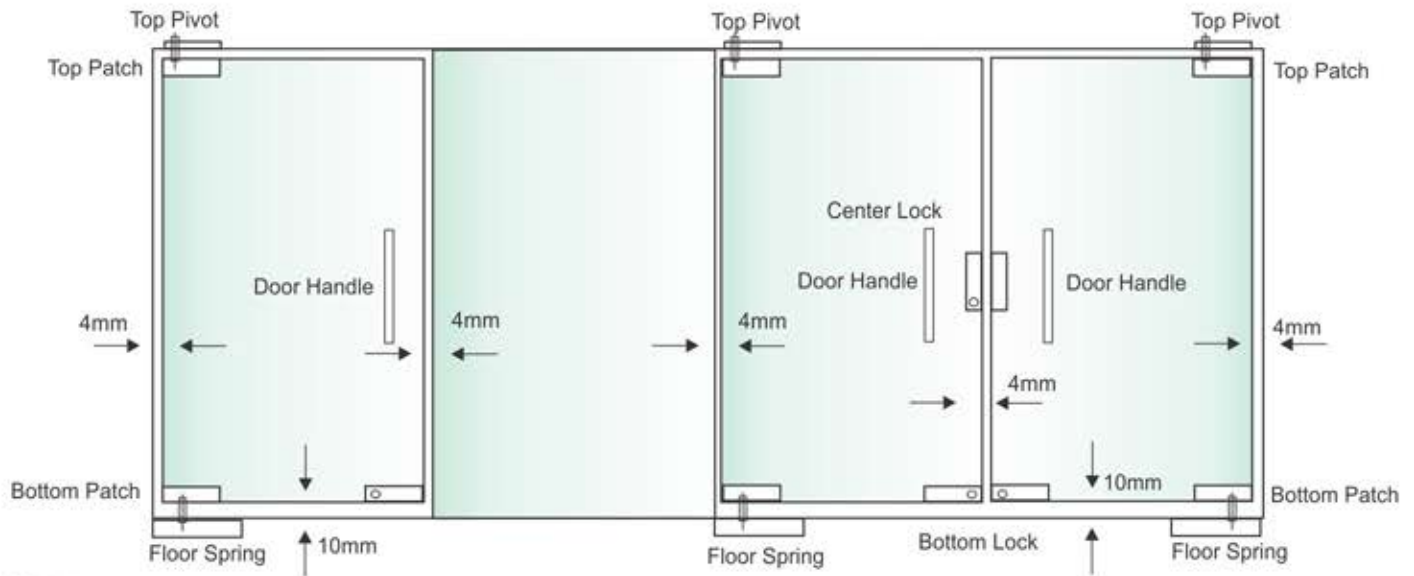

**KPF-02**  
Top Patch

- Specification**
- Finish : Satin stainless steel
  - Pivot point of 55 / 65mm
  - With SS 304 cover of 1.2mm thickness
  - High quality tempered precision screws are used to ensure solid gripping

Also Available in Premium Series

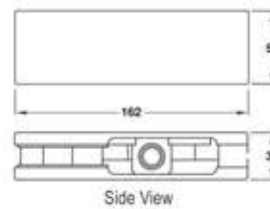

Also Available in Premium Series



**KPF-03**  
Bottom Patch

- Specification**
- Finish : Satin stainless steel
  - Suitable for reputed manufacturer Floor Hinge
  - Pivot point of 55 / 65mm
  - With SS 304 cover of 1.2mm thickness
  - High quality tempered precision screws are used to ensure solid gripping

Also Available in Premium Series

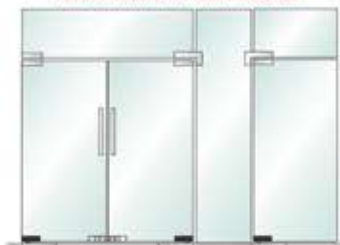

**KPL-01**  
Lock Patch

- Specification**
- Finish : Satin stainless steel Suitable to Lock swing doors.
  - With a euro profile cylinder and strike plate
  - with 3 high Security computerized keys
  - Single Throw Rectangular Bolt with 15mm Projection
  - With SS 304 cover of 1.2mm thickness
  - High quality tempered precision screws are used to ensure solid gripping

Also Available in Premium Series

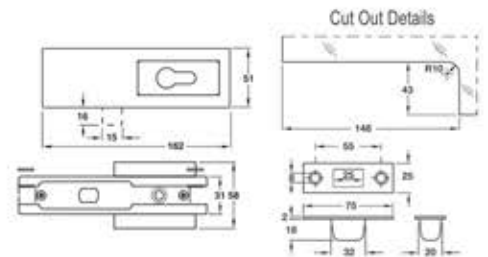

**KPL-02A (Center Lock Patch)**  
**KPL-02B (Lock Strike Box)**

- Specification**
- Finish : Satin stainless steel
  - Suitable to Lock double doors.
  - strike box for KPL-02
  - With SS 304 cover of 1.2mm thickness
  - High quality tempered precision screws are used to ensure solid gripping

Also Available in Premium Series

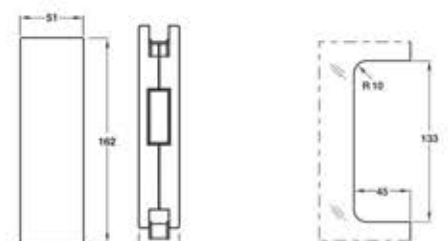







**KPF-640**  
Wall to Glass Connecting Patch

**Specification**

- Finish : Satin stainless steel
- Suitable for fixing glass with ceiling, floor & wall
- For fixing with fixed structure
- With SS 304 cover of 1.2mm thickness
- High quality tempered precision screws are used to ensure solid gripping

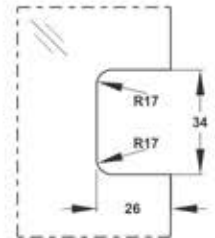
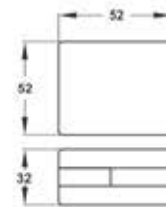
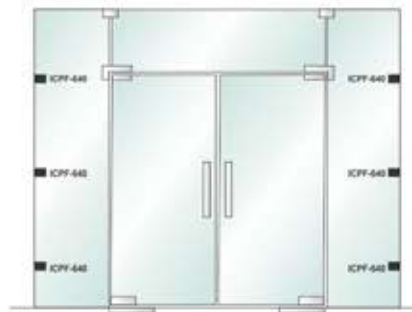

**KPF-610ST**  
Small L with Stopper

**Specification**

- Finish : Satin stainless steel
- Suitable for fixing over panel & side panel at the opening top corner of the door also restricts one side opening of the door
- Square look from one side & L shape from another side
- With SS 304 cover of 1.2mm thickness
- Cover fixed with Allen screw to ensure that the cover remained secure in its place

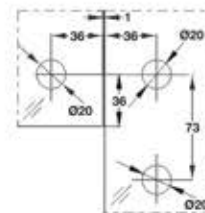

Cut Out Details

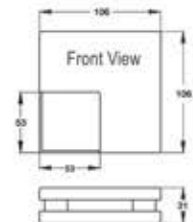

Side View



**KPF-51**  
Double Over Panel Patch with Fin

**Specification**

- Finish : Satin stainless steel
- Suitable for back to back doors with pivot along with fin
- Over panel with pivot for back to back doors
- With SS 304 cover of 1.2mm thickness
- High quality tempered precision screws are used to ensure solid gripping



(View from inside)

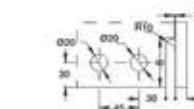

Cut Out Details

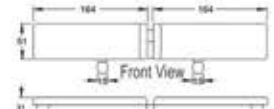

Side View



**KPF-41R**  
Over Panel Side Panel Connector with Fin (Right)

**Specification**

- Finish : Satin stainless steel
- Suitable for fixing over panel & side panel along with fin
- Over panel side panel with fin inside
- With SS 304 cover of 1.2mm thickness
- High quality tempered precision screws are used to ensure solid gripping

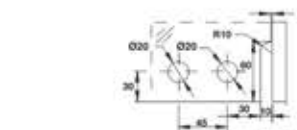
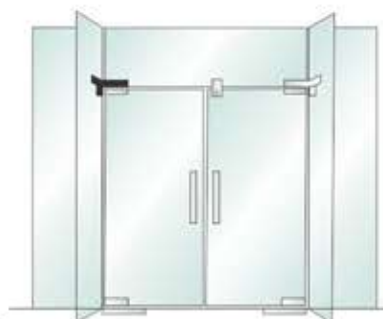

Cut Out Details

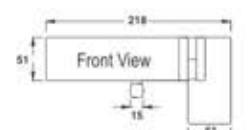

Side View



**SKPF-41L**  
Over Panel Side Panel Connector with Fin (Left)

**Specification**

- Finish : Satin stainless steel
- Suitable for fixing over panel & side panel along with fin
- Over panel side panel with fin inside
- With SS 304 cover of 1.2mm thickness
- High quality tempered precision screws are used to ensure solid gripping

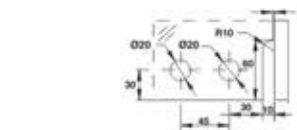

Cut Out Details

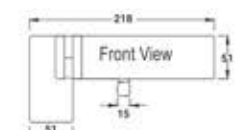

Side View

# PATCH FITTINGS



## KPL-3A Latch Lock

### Specification

- Finish : Satin stainless steel (SSS)
- Suitable to lock swing sliding & sliding doors.
- Can also be use to lock the door from center/top
- Thumb turn lock with single throw
- With SS 304 cover of 1.2mm thickness
- High quality tempered precision screws are used to ensure solid gripping

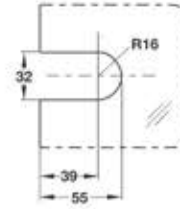

Cut Out Details

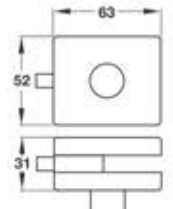

Side View



## KPL-3B Strike Box

### Specification

- Finish : Satin stainless steel (SSS)
- Suitable as strike box swing sliding doors
- With SS 304 cover of 1.2mm thickness
- High quality tempered precision screws are used to ensure solid gripping

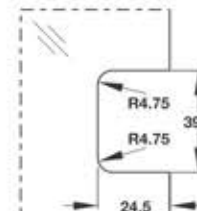

Cut Out Details

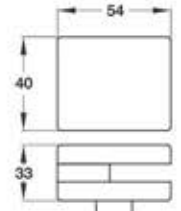

Side View



## KPF-630F Connector with Fin

### Specification

- Finish : Satin stainless steel
- Suitable for fixing two fixed glasses in line with fin inside.
- For fixing two glasses in line with fin inside
- With SS 304 cover of 1.2mm thickness
- High quality tempered precision screws are used to ensure solid gripping



(View from inside)

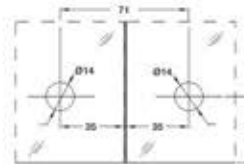

Cut Out Details

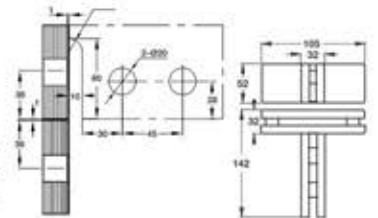

Cut Out Details



## KPF-610L/R Triple Glass Patch Connector with Fin (Left/Right)

### Specification

- Finish : Satin stainless steel
- Suitable for fixing over panel & side along with fin to be used at the opening top corner of the door.
- L / R shape from outside with fin inside
- With SS 304 cover of 1.2mm thickness
- High quality tempered precision screws are used to ensure solid gripping



(View from inside)

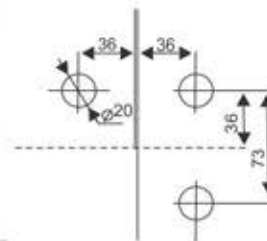

Cut Out Details

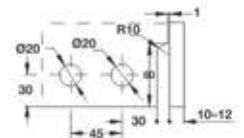

## KFS-MFH Mini Floor Hinge

### Specification

- Finish : Satin stainless steel
- High quality tempered precision screws are used to ensure solid gripping



## KFS-GDP Top Pivot

### Specification

- Wear resistant Stainless Steel 304 Pivot Pin
- Finish : Satin stainless steel
- Suitable for fixing Door with Top Patch





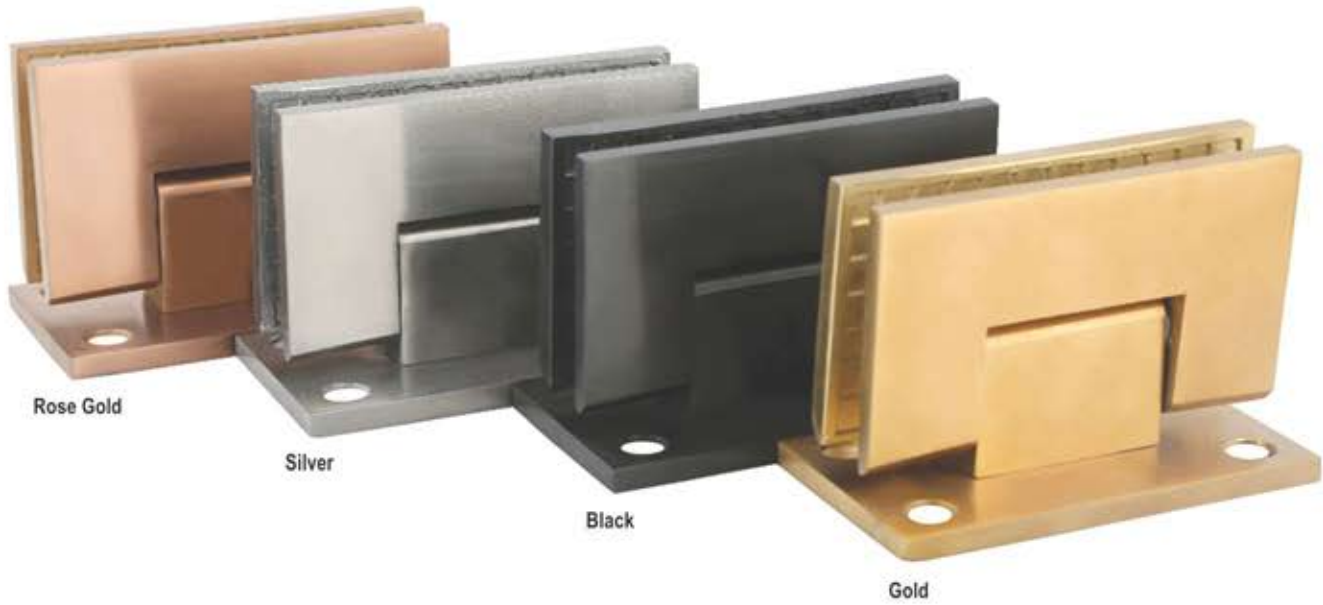

**Premium colours (Rose Gold, Silver, Black and Gold) are available in Floor Hinge, Patch Fitting, Shower Hinges, Glass Connectors, Shower Knight Accessories and Door Handles.**





# SHOWER HINGES



## Forged Zinc

Shower Hinges Also Available in Premium Series



**KSH-1 H/P**  
Wall to Glass 90° Off Set Hinge  
Material : Forged Zinc  
Door Thickness : 8mm-12mm  
Weight Cap. : 45kg  
Finish : Matt & Chrome Plated  
With Gasket to Prevent Glass from Damage

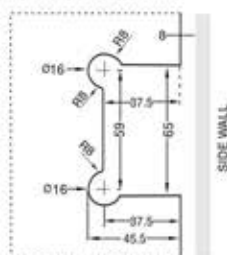

**KSH-11 H/P**  
Wall to Glass 90° Off Set Hinge  
Material : SS 304  
Door Thickness : 8mm-12mm  
Weight Cap. : 45kg  
Finish : Matt & PSS Finish  
With Gasket to Prevent Glass from Damage



**KSH-1**  
Wall to Glass 90° Hinge  
Material : Forged Zinc  
Door Thickness : 8mm-12mm  
Weight Cap. : 45kg  
Finish : Matt & Chrome Plated  
With Gasket to Prevent Glass from Damage

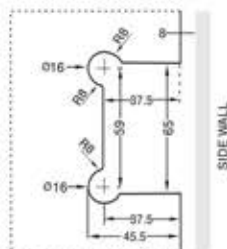

**KSH-11**  
Wall to Glass 90° Hinge  
Material : SS 304  
Door Thickness : 8mm-12mm  
Weight Cap. : 45kg  
Finish : Matt & PSS Finish  
With Gasket to Prevent Glass from Damage



**KSH-2**  
Glass to Glass 180° Hinge  
Material : Forged Zinc  
Door Thickness : 8mm-12mm  
Weight Cap. : 45kg  
Finish : Matt & Chrome Plated  
With Gasket to Prevent Glass from Damage

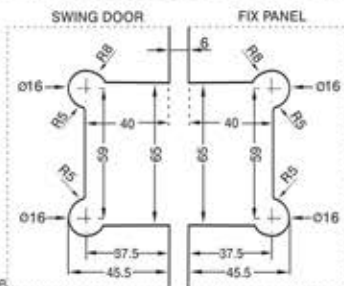

**KSH-12**  
Glass to Glass 180° Hinge  
Material : SS 304  
Door Thickness : 8mm-12mm  
Weight Cap. : 45kg  
Finish : Matt & PSS Finish  
With Gasket to Prevent Glass from Damage



**KSH-3**  
Glass to Glass 135° Hinge  
Material : Forged Zinc  
Door Thickness : 8mm-12mm  
Weight Cap. : 45kg  
Finish : Matt & Chrome Plated  
With Gasket to Prevent Glass from Damage

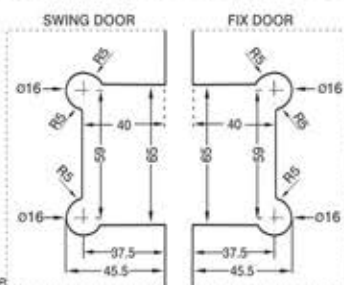

**KSH-13**  
Glass to Glass 135° Hinge  
Material : SS 304  
Door Thickness : 8mm-12mm  
Weight Cap. : 45kg  
Finish : Matt & PSS Finish  
With Gasket to Prevent Glass from Damage



**KSH-4**  
Glass to Glass 90° Hinge  
Material : Forged Zinc  
Door Thickness : 8mm-12mm  
Weight Cap. : 45kg  
Finish : Matt & Chrome Plated  
With Gasket to Prevent Glass from Damage

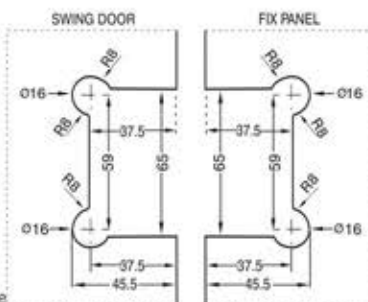

**KSH-14**  
Glass to Glass 90° Hinge  
Material : SS 304  
Door Thickness : 8mm-12mm  
Weight Cap. : 45kg  
Finish : Matt & PSS Finish  
With Gasket to Prevent Glass from Damage



**KSH-5**  
Wall to Glass 90° Fix Bracket  
Material : Forged Zinc  
Door Thickness : 8mm-12mm  
Weight Cap. : 45kg  
Finish : Matt & Chrome Plated  
With Gasket to Prevent Glass from Damage

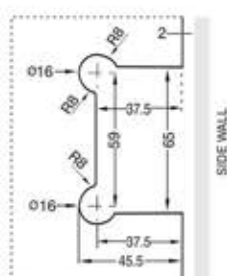

**KSH-15**  
Wall to Glass 90° Fix Bracket  
Material : SS 304  
Door Thickness : 8mm-12mm  
Weight Cap. : 45kg  
Finish : Matt & PSS Finish  
With Gasket to Prevent Glass from Damage

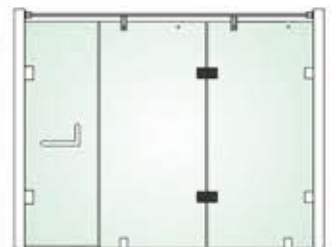
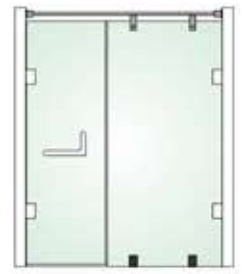



# GLASS CONNECTORS



## 4mm Stainless Steel 304

## 4mm Solid Stainless Steel 304

Glass Connectors Also Available in Premium Series



**KGC-01 A**  
Fix Clip Connector  
(Single Hole)

Material - Stainless Steel 304  
Door Thickness - 8mm-12mm  
Finish - Satin Stainless Steel & CP  
With Gasket to Prevent Glass from Damage

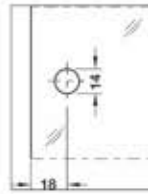

**KGC-11 A**  
Fix Clip Connector  
(Single Hole)

Material - Stainless Steel 304  
Door Thickness - 8mm-12mm  
Finish - Satin Stainless Steel  
Product Thickness - 4mm  
With Gasket to Prevent Glass from Damage



**KGC-01**  
U Connector

Material - Stainless Steel 304  
Door Thickness - 8mm-12mm  
Finish - Satin Stainless Steel & CP  
With Gasket to Prevent Glass from Damage

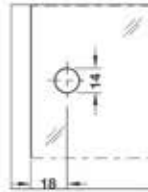

**KGC-11**  
U Connector

Material - Stainless Steel 304  
Door Thickness - 8mm-12mm  
Finish - Satin Stainless Steel  
Product Thickness - 4mm  
With Gasket to Prevent Glass from Damage



**KGC-02**  
Glass to Glass 135°

Material - Stainless Steel 304  
Door Thickness - 8mm-12mm  
Finish - Satin Stainless Steel & CP  
With Gasket to Prevent Glass from Damage

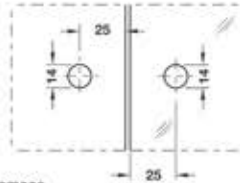

**KGC-12**  
Glass to Glass 135°

Material - Stainless Steel 304  
Door Thickness - 8mm-12mm  
Finish - Satin Stainless Steel  
Product Thickness - 4mm  
With Gasket to Prevent Glass from Damage



**KGC-03**  
Glass to Glass 90°

Material - Stainless Steel 304  
Door Thickness - 8mm-12mm  
Finish - Satin Stainless Steel & CP  
With Gasket to Prevent Glass from Damage

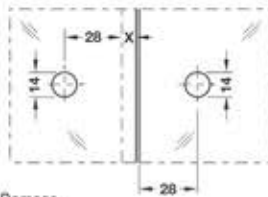

**KGC-13**  
Glass to Glass 90°

Material - Stainless Steel 304  
Door Thickness - 8mm-12mm  
Finish - Satin Stainless Steel  
Product Thickness - 4mm  
With Gasket to Prevent Glass from Damage



**KGC-04**  
L Connector

Material - Stainless Steel 304  
Door Thickness - 8mm-12mm  
Finish - Satin Stainless Steel & CP  
With Gasket to Prevent Glass from Damage

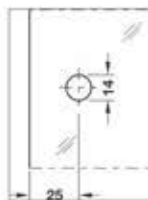

**KGC-14**  
L Connector

Material - Stainless Steel 304  
Door Thickness - 8mm-12mm  
Finish - Satin Stainless Steel  
Product Thickness - 4mm  
With Gasket to Prevent Glass from Damage



**KGC-05**  
Glass to Glass 180°

Material - Stainless Steel 304  
Door Thickness - 8mm-12mm  
Finish - Satin Stainless Steel & CP  
With Gasket to Prevent Glass from Damage

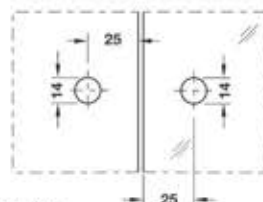

**KGC-15**  
Glass to Glass 180°

Material - Stainless Steel 304  
Door Thickness - 8mm-12mm  
Finish - Satin Stainless Steel  
Product Thickness - 4mm  
With Gasket to Prevent Glass from Damage



**KGC-06**  
Glass to Wall 180°

Material - Stainless Steel 304  
Door Thickness - 8mm-12mm  
Finish - Satin Stainless Steel & CP  
With Gasket to Prevent Glass from Damage

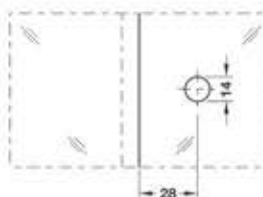

**KGC-16**  
Glass to Wall 180°

Material - Stainless Steel 304  
Door Thickness - 8mm-12mm  
Finish - Satin Stainless Steel  
Product Thickness - 4mm  
With Gasket to Prevent Glass from Damage

## Round Series (Dia 19mm)

Shower Knight Head Acc. Also Available in Premium Series



**KSKH-01**  
Wall to Rod

- Specification**
- Finish : Satin Nikle/Chrome Plated
  - Material : Stainless Steel 304 Grade
  - Reinforcing connector wall to rod

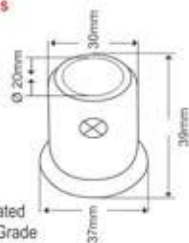

## Rectangle Series (30x10mm)



**KSSKH-11-ED**  
Wall to Track Connector

- Specification**
- For mounting with wall
  - Rectangular design
  - With two grub screws to prevent relative movement
  - Material : SS 304 Grade

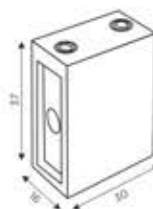

**KSKH-02**  
Wall to Glass

- Specification**
- Finish : Satin Nikle/Chrome Plated
  - Material : SS 304 Grade
  - Reinforcing connector rod to glass

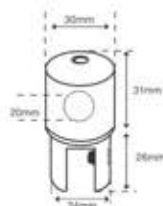

**KSSKH-12-ED**  
Track to Glass Connector

- Specification**
- For mounting with wall
  - Rectangular design
  - With two grub screws to prevent relative movement
  - Material : SS 304 Grade



**KSKH-03**  
Rod to Rod Connector

- Specification**
- Finish : Satin Nikle/Chrome Plated
  - Material : SS 304 Grade
  - Reinforcing connector rod to rod (Adjustable Angle)

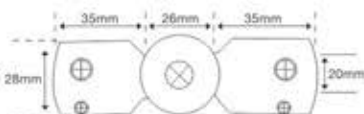

**KSSKH-13-ED**  
Track to Track Connector

- Specification**
- Glass to track end connector
  - With two grub screws to prevent relative movement
  - Material : SS 304 Grade

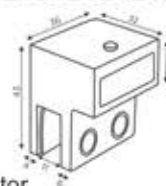

**KSKH-04**  
Rod to Rod T Connector

- Specification**
- Finish : Satin Nikle/Chrome Plated
  - Material : SS 304 Grade
  - Reinforcing connector rod to rod (T-Type)

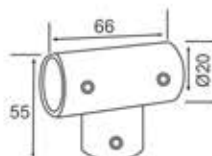

**KSKH-ACC-T-ED**  
Shower Sliding Track

- Specification**
- Rectangular design
  - Material : SS 304 Grade

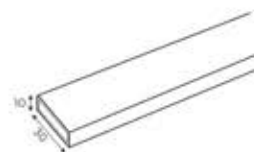

**KSKH-05**  
Rod to Glass Connector

- Specification**
- Finish : Satin Nikle/Chrome Plated
  - Material : SS 304 Grade
  - Reinforcing connector rod to glass (One side blind)

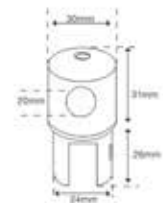

**KSKH-ACC-19**  
Reinforcing Rod

- Specification**
- 19mm outer diameter pipe
  - Available in 2 & 3 mtr. length
  - Material : Stainless Steel 304 Grade

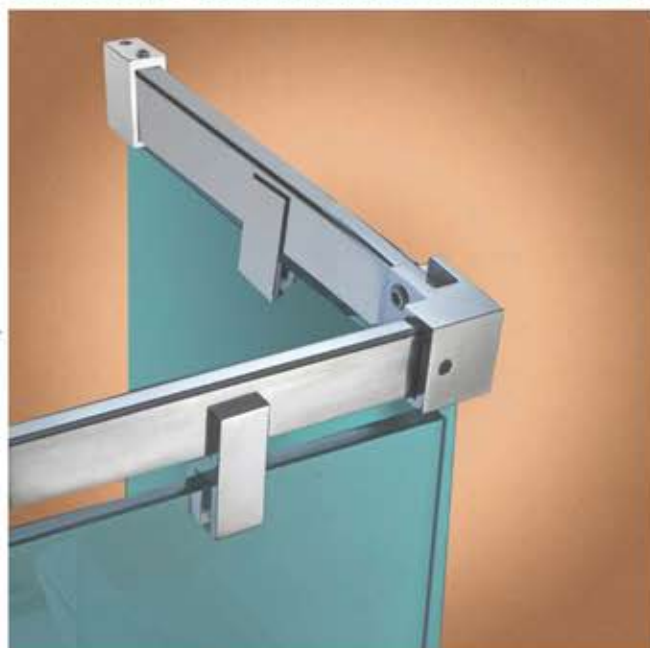
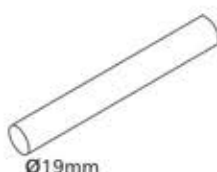

# PLASTIC PROFILES



**KPS-01**  
Wall Seal

- Specification**
- For : 8/10/12mm Glass
  - Size : 2.2mtr. and 2.5 mtr.
  - Finish : Transparent



**KPS-02**  
Center Seal

- Specification**
- For : 8/10/12mm Glass
  - Size : 2.2mtr. and 2.5 mtr.
  - Finish : Transparent



**KPS-03**  
Side Seal

- Specification**
- For : 8/10/12mm Glass
  - Size : 2.2mtr. and 2.5 mtr.
  - Finish : Transparent



**KPS-04**  
D Seal

- Specification**
- For : 8/10/12mm Glass
  - Size : 2.2mtr. and 2.5 mtr.
  - Finish : Transparent



**KPS-10**  
Water Desperse Seal

- Specification**
- For : 8/10/12mm Glass
  - Size : 2.2mtr. and 2.5 mtr.
  - Finish : Transparent

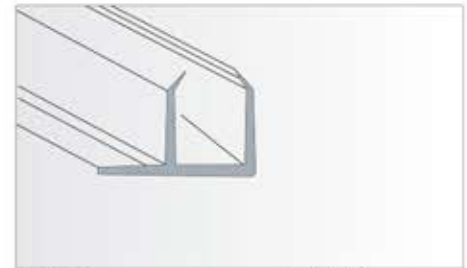

**KPS-09**  
Sliding Door Seal

- Specification**
- For : 8/10/12mm Glass
  - Size : 2.2mtr. and 2.5 mtr.
  - Finish : Transparent

## Magnetic Profiles

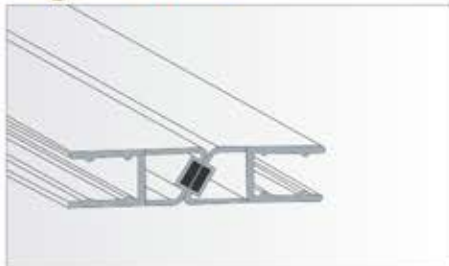

**KPS-M1**  
180° Magnetic Seal

- Specification**
- For : 8/10/12mm Glass
  - Size : 2.2mtr. and 2.5 mtr.
  - Finish : Transparent



**KPS-M2**  
135° Magnetic Seal

- Specification**
- For : 8/10/12mm Glass
  - Size : 2.2mtr. and 2.5 mtr.
  - Finish : Transparent



**KPS-M3**  
90° Magnetic Seal

- Specification**
- For : 8/10/12mm Glass
  - Size : 2.2mtr. and 2.5 mtr.
  - Finish : Transparent

# REINFORCING BARS



**KRB-1**  
Reinforcing Bar

- Specification**
- Gaskets to prevent glass damage
  - Telescopic construction
  - Length adjustable from 890mm to 1520mm Left Right adjustment at wall end
  - Firm positioning of the glass panels
  - Material SS Grade 304
  - Finish: PSS



**KRB-2**  
Reinforcing Bar

- Specification**
- Gaskets to prevent glass damage
  - Telescopic construction
  - Length adjustable from 890mm to 1520mm
  - Firm positioning of the glass panels
  - Material SS Grade 304
  - Finish: PSS

# SHOWER DOOR KNOBS



**KDK-01**  
Door Knob

- Specification**
- Finish : Satin Nikle/Chrome Plated
  - Material : SS 304 Grade
  - Glass door knob



**KDK-02**  
Door Knob

- Specification**
- Finish : Satin Nikle/Chrome Plated
  - Material : SS 304 Grade
  - Glass door knob



### KSL-01 Roller SS (Set)

- Specification**
- Four fiber reinforced plastic rollers of 30 mm diameter
  - Stainless Steel Grade 304 glass holding point
  - Height adjustable glass holding points (10 mm)
  - Secure grip for the door
  - Self aligning suspension of door
  - Roller configuration for even distribution of load
  - Independently connected rollers to prevent damage to track and rollers
  - Suitable for 10 mm or 12 mm glass
  - Suitable for door weight 60 kg.



CUTOUT DETAILS OF SSL-44-A1

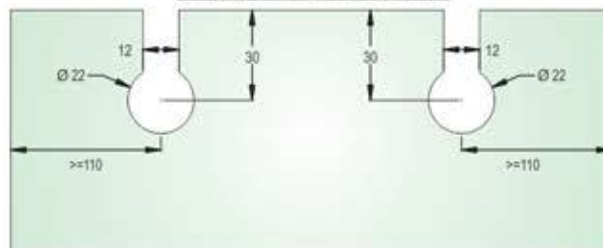

### KSL-02 Roller Brass (Set)

- Specification**
- Heavy duty sliding door roller
  - Suitable for up to a door weight of 100 Kg
  - Larger surface area for secure grip of the door
  - Adjustable threaded rod for installation perfection
  - Solid brass for glass holding



CUTOUT DETAILS OF SSL-44-A2

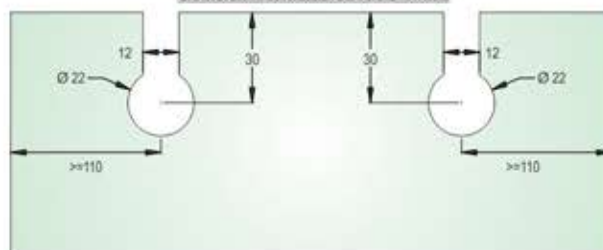

### KSL-04 8 Wheel Rectangular Roller SS (Set)

- Specification**
- Material : Stainless steel 304 grade
  - Finish : Satin stainless steel (SSS)



CUTOUT DETAILS OF SSL-44-R8

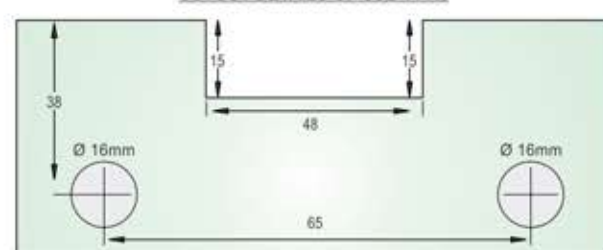

# OFFICE SLIDING SYSTEM



**KSL-03**  
Stopper

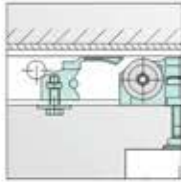

**KSL-05**  
Wall to Track Clamp

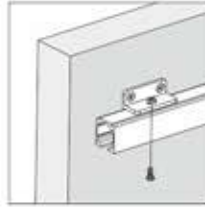

**KSL-06**  
Glass to Track Clamp

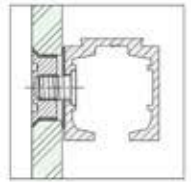

**KSL-09**  
Track End Cap

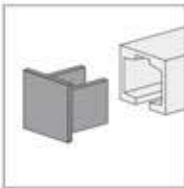

**KSL-33G**  
Floor Guide



**KSL-HN 50**  
Sliding Door Handle

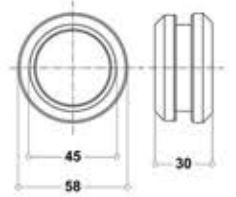

**KSL-HN 60**  
Sliding Door Handle



**KSL-HN 40**  
Rectangle Handle

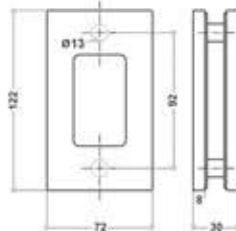

**KSL-HN 10**  
Rectangle Handle

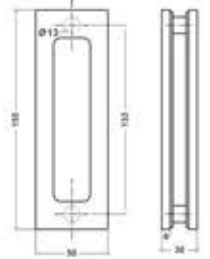

**KSL-HN 20**  
Square Handle

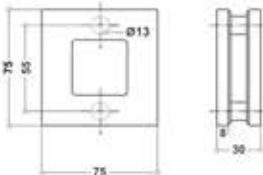

**KSSPL-SDL-01**  
Sliding Door Lock with Strike Plate

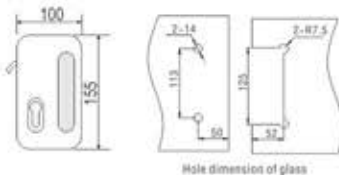

**KSSPL-SDL-02**  
Sliding Door Lock with Strike Box

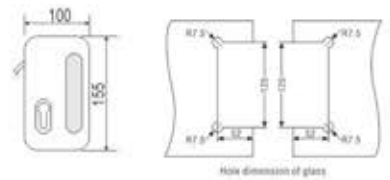

**KSL-B1 Track**  
Aluminium Track (Single Door)  
Available in 3 & 4mtr.



**KSL-B2 Track**  
Aluminium Track (Double Door)  
Available in 3 & 4mtr.

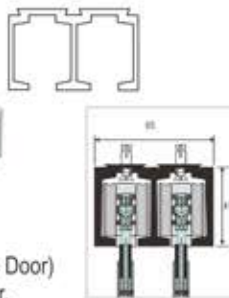

**KSL-B3 Track**  
Aluminium Track (Door + Fix Glass)  
Available in 3 & 4mtr.

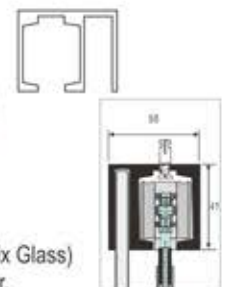





**KSL-33A**  
Office Sliding Roller

**Specification**

- Material : Stainless Steel • Glass Thickness : 8mm-12mm
- Weight Cap. : 150kg • Finish : SSS
- Non Countersunk Hole



Glass  
Hole Diameter  
26mm

Size

55  
50  
26



**KSL-33A (Set)**  
Office Sliding Roller (2)

Glass to Rod Clamp (4)



Floor Guide 1



Door Stopper (2)



**KSL-55A**  
Office Sliding Roller

**Specification**

- Material : Stainless Steel • Glass Thickness : 8mm-12mm
- Weight Cap. : 150kg • Finish : SSS
- Non Countersunk Hole

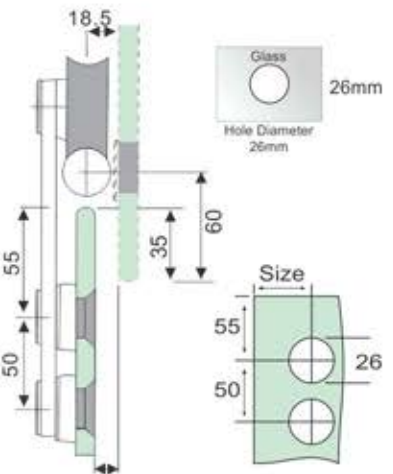

Glass  
Hole Diameter  
26mm

Size

55  
50  
26



**KSL-55A (Set)**  
Office Sliding Roller (2)

Glass to Rod Clamp (4)



Floor Guide 1



Door Stopper (2)

# SLIDING DOOR SYSTEM



**KSL-33-TH-G2**  
Glass to Rod Clamp



**KSL-33-TH**  
Wall to Rod Clamp

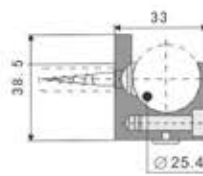

**KSL-33-TH-WL**  
Wall to Rod Holder

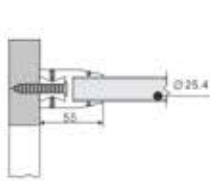

**KSL-33S**  
Door Stopper L/R



**KSL-33G**  
Floor Guide

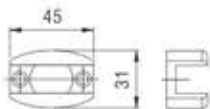

**KSL-30L**  
Sliding Door Lock (Glass to Glass)

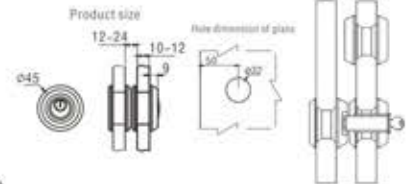



**KSL-11-ED-A1**  
Roller

**Specification**

- Independent needle bearings
- Eccentrically mounted rollers
- Bottom glass fixing point adjustable
- Countersunk head for better grip and look
- Glass thickness 8 - 10mm
- Stainless Steel Grade 304
- Finish : SSS & PSS



**KSL-11-ED-A2**  
Track to Glass Roller

**Specification**

- Firm grip with glass & track
- Stainless Steel Grade 304
- Finish : SSS & PSS



**KSL-11-ED-A3**  
Stopper

**Specification**

- Stopper with bumper
- Easily Slides in the track and held with grub screw
- Stainless Steel Grade 304
- Finish : SSS & PSS



**KSL-11-ED-A4**  
Floor Guide

**Specification**

- Double Guide to hold Fixed and Moving Glass
- Controls movement of Sliding Glass
- Stainless Steel Grade 304
- Finish : SSS & PSS



**KSSKH-11-ED**  
Wall to Track Connector

**Specification**

- For mounting with wall
- Rectangular design
- With two grub screws to prevent relative movement
- Material : Stainless Steel 304 Grade
- Finish : SSS & PSS



**KSSKH-12-ED**  
Track to Glass Connector

**Specification**

- For Connecting Glass to Track
- With two grub screws to prevent relative movement
- Material : Stainless Steel 304 Grade
- Finish : SSS & PSS

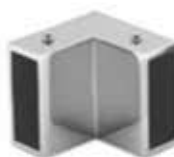

**KSSKH-13-ED**  
Track Connector 90°

**Specification**

- For Connecting Track at 90°
- Rectangular design
- With two grub screws to prevent relative movement
- Material : Stainless Steel 304 Grade
- Finish : SSS & PSS



**KSSKH-AC-T-ED**  
Shower Sliding Track  
(Available in 1.5 Mt, 1.8 Mt & 2.1 Mt)

**Specification**

- Rectangular design
- Available in 1.5 Mt, 1.8 Mt & 2.1 Mt. length
- Material : Stainless Steel 304 Grade
- Finish : SSS & PSS



# CANOPY FITTING



**KCF-01-S**  
Wall to Glass Connector

- Specification**
- Finish : Satin stainless steel (SSS)
  - Suitable for canopies in interior & exterior
  - Stainless steel 304 grade
  - To fix glass with the wall
  - Adjustable angle
  - Washer to prevent glass from damage

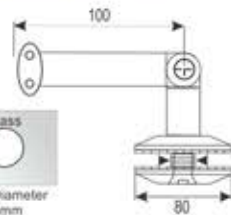

**KCF-02-S**  
Rod to Glass Connector

- Specification**
- Finish : Satin stainless steel (SSS)
  - Suitable for holding canopy glass with rod along with wall to rod
  - Stainless steel 304 grade
  - To hold canopy glass with rod
  - Adjustable angle
  - Washer to prevent glass from damage

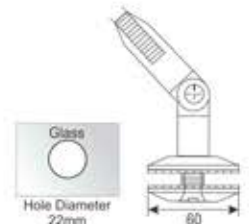

**KCF-03-S**  
Wall to Glass Connector

- Specification**
- Finish : Satin stainless steel (SSS)
  - Suitable for holding wall to rod with wall
  - Stainless steel 304 grade
  - To hold rod with the wall
  - Adjustable angle
  - Washer to prevent glass from damage

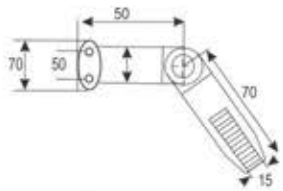

**KCF-02**  
Adjustable Glass Connector

- Specification**
- Finish : Satin stainless steel (SSS)
  - Suitable for canopies in interior & exterior
  - Stainless steel 304 grade
  - To be used with with KCF-33 with Cable / Rod
  - Length Adjustable
  - Flat head Bolt and Washer to prevent glass from damage

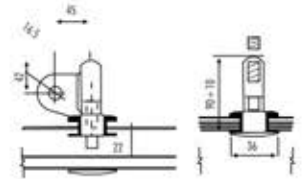

**KCF-03**  
Wall Connector

- Specification**
- Finish : Satin stainless steel (SSS)
  - Suitable for canopies in interior & exterior
  - Stainless steel 304 grade
  - To be used with KCF-22 with a cable / Rod
  - More Gripping Surface
  - Firm base to have a secure seating

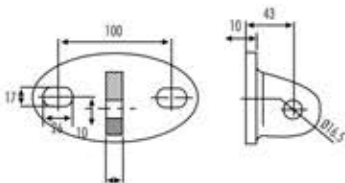

**KCF-ROD (16mm)**  
Connecting for Canopy

- Specification**
- Finish : Satin stainless steel (SSS)
  - Suitable for fixing with pivot pole (top)
  - Stainless steel 304 grade
  - To be fix to a secured over panel
  - Available with countersunk/flat head





Two Way Open



One Way Open



**KSF-6**  
Glass to Glass Center Hinge

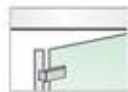

**KSF-9**  
Wall to Glass Hinge



**KSF-10**  
Center Hinge with Roller



**KSF-11**  
End Hinge with Roller



**KSF-12**  
Glass to Glass Center Hinge with Guide



**KSF-13 L/R**  
Glass to Glass Center Hinge with Lock



**KSF-14**  
End Hinge with Guide



**KSSF-16**  
Fixed Hinge



**KSF-17**  
Floor Fixed Hinge

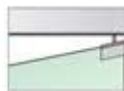

**KSF-18 L/R**  
End Panel Fitting with Bottom Pivot



**SKSF-19**  
Floor Track Bottom (S.S.)



**KSF-20**  
Aluminium Track (Top)

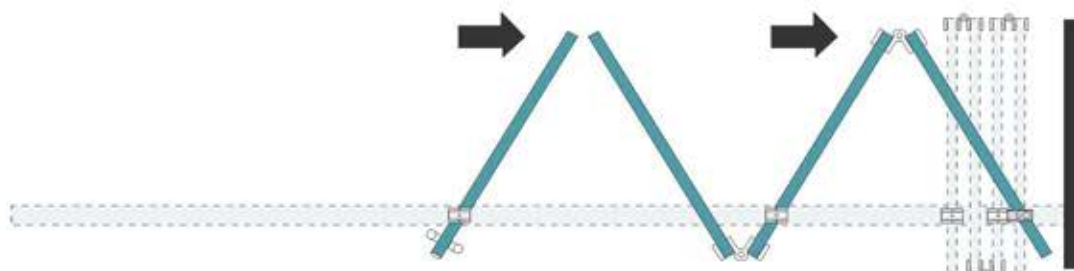

# CENTER SLIDING FOLDING SYSTEM



**KCSF-1**  
Folding Door Roller



**KCSF-2**  
Glass to Wall Hinge



**KCSF-3**  
Glass to Glass Hinge



**KCSF-LK**  
Sliding Glass Door Lock



**KCSF-5**  
Knob Sleeve



**KCSF-6**  
Aluminium Track

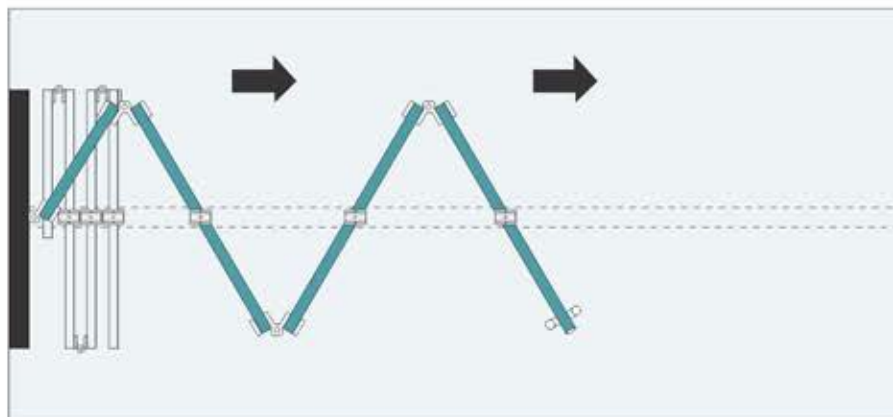



## KASD-1 Automatic Sensor Door

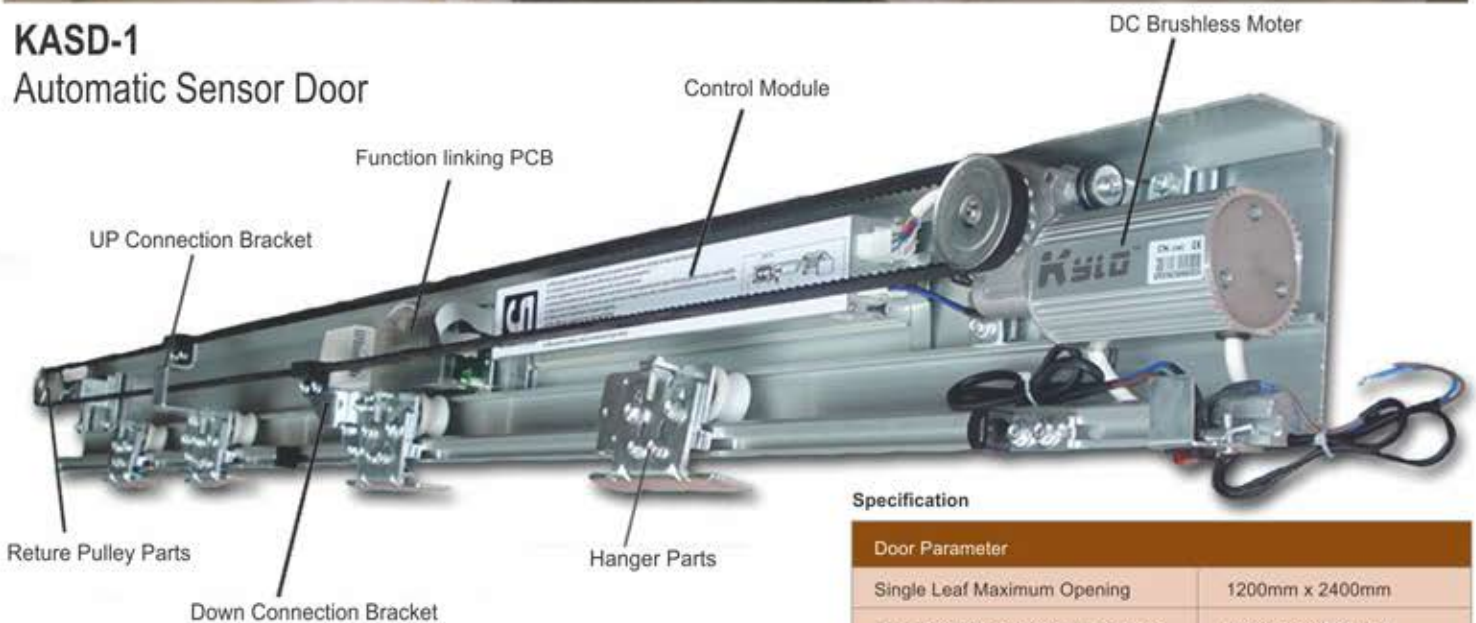

### Specification

Door Parameter	
Single Leaf Maximum Opening	1200mm x 2400mm
Bi-parting Door Maximum Opening	2200mm x 2400mm
Maximum Door Weight Single Leaf	75kg to 90kg (Single Door)
Maximum Door Weight Double Leaf	75kg x 2 Door (Bi-parting)

### AUTOMATIC DOOR PARAMETER

TYPE	
Opening Speed	Adjust Between 250-600mm/Sec.
Closing Speed	Adjust Between 150-300mm/Sec.
Holding Time	1-15 Sec.
Pushing Force	<37N      <45N
Power	Ac 200-250V
Voltage	DC 24V-50W
Environment Temperature	-200C - +500C

### Features and advantages

- Intelligent control system.
- Drive equipment with low noise.
- Advanced brush less motor and worm wheel reducer are integrated.
- Special self-locking function without any addition components.
- With different triggered opening modes.
- Double door interlock function.
- Optional power supply backup to ensure the normal operation.
- When door is closed, it shall be locked and kept closed.
- Apply to doors for garage, usage of anti-radiation for hospitals, warehouses, science and technology factories, barrier-free space, commercial building, shopping mall, etc.
- Easy installation & low maintenance.
- Track size : 4200mm/6400mm.

# SPIDER FITTINGS

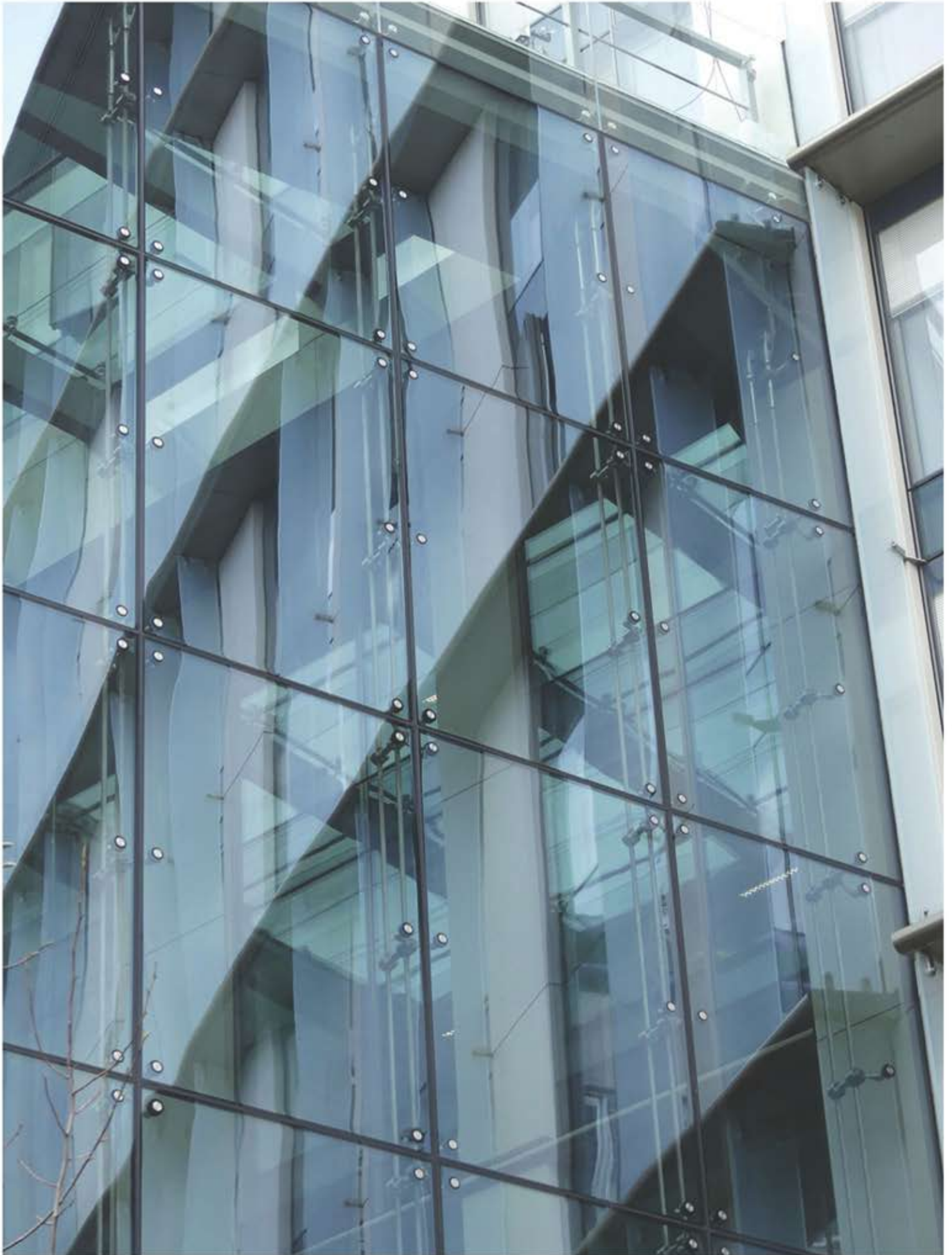

# SPIDER FITTINGS

## Spider without Fin



**KSF-B1**  
One Way Spider without Fin

- Specification**
- 160 mm arm
  - One Way Spider without fin to hold the glass at one point
  - Material : Stainless Steel 304 Grade
  - Hold glass with the help of articulated/fix routel.
  - Designed to hold with fix structure

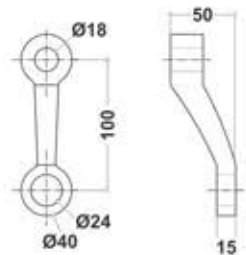

**KSF-B2 (90°)**  
Two Way Spider without Fin

- Specification**
- Two Way Spider without fin to hold two glass panels at 90° with fixed structure.
  - Material : Stainless Steel 304 Grade
  - Hold glass with the help of articulated/fix routels.
  - Designed to hold with fix structure

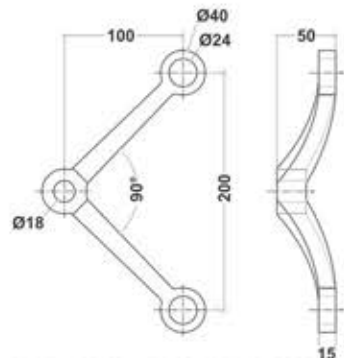

**KSF-B2A (180°)**  
Two Way Spider without Fin

- Specification**
- 220 mm arm
  - Two Way Spider without fin to hold two glass panels at 180° with fixed structure.
  - Material : Stainless Steel 304 Grade
  - Hold glass with the help of articulated/fix routels.
  - Designed to hold with fix structure

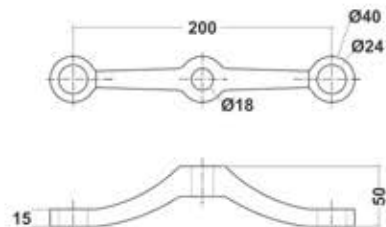

**KSF-B3**  
Three Way Spider without Fin

- Specification**
- Three Way Spider without fin to hold three glass panels
  - Material : Stainless Steel 304 Grade
  - Hold glass with the help of articulated/fix routels.
  - Designed to hold with fix structure

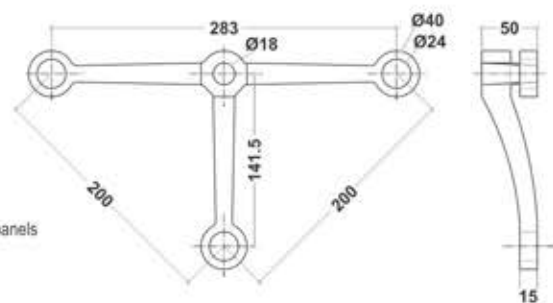

**KSF-B4**  
Four Way Spider without Fin

- Specification**
- Four Way Spider without fin to hold four glass panel to gether with fixed structure
  - Material : Stainless Steel 304 Grade
  - Hold glass with the help of articulated/fix routel.
  - Designed to hold with fix structure

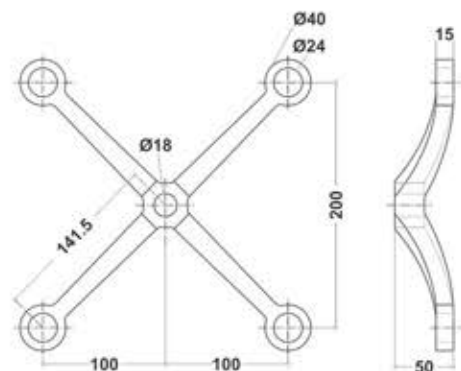

# SPIDER FITTINGS

## Spider with Fin

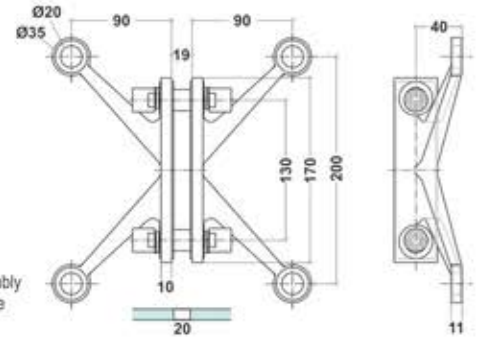
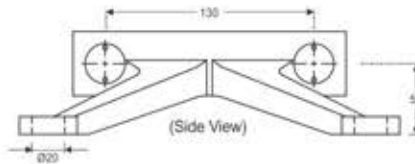

**KSF-A4**  
Four Way Spider with Fin

- Specification**
- Four Way Spider with fin to suit two/four panel glass assembly
  - With gasket & teflon washers to prevent glass from damage
  - Hold glass with the help of articulated/fix routels

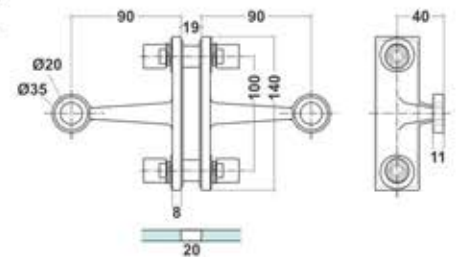
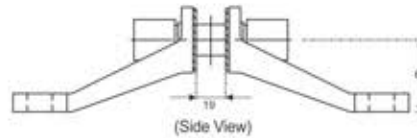

**KSF-A2**  
Two Way Spider with Fin

- Specification**
- Two Way Spider with fin to suit two panel glass assembly
  - With gasket & teflon washers to prevent glass from damage
  - Hold glass with the help of articulated/fix routels

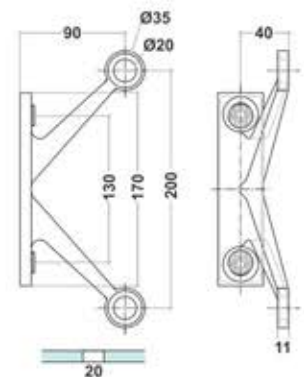
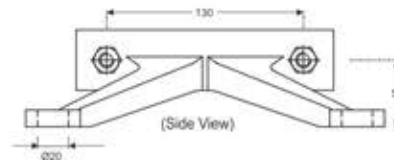

**KSF-A44**  
Two Way Spider with Fin  
(Wall Mounted)

- Specification**
- Two Way Spider with fin to suit two panel wall assembly
  - With gasket & teflon washers to prevent glass from damage
  - Hold glass with the help of articulated/fix routels

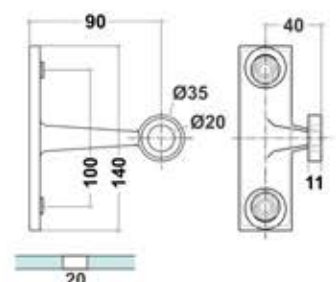
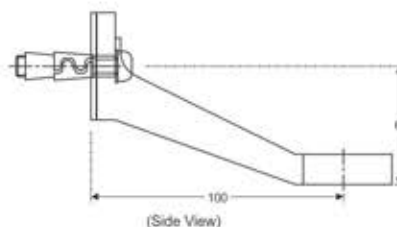

**KSF-A22**  
One Way Spider with Fin  
(Wall Mounted)

- Specification**
- One Way Spider with fin to suit one panel wall assembly
  - With gasket & teflon washers to prevent glass from damage
  - Hold glass with the help of articulated/fix routels



**KSP-AFB-FH**  
Articulated Routel

- Specification**
- Articulated flat head routel to be used along with spiders to hole glass
  - Material : Stainless Steel 304 Grade
  - With teflon washers to prevent glass from damage
  - Adjustable upto 15mm glass thickness

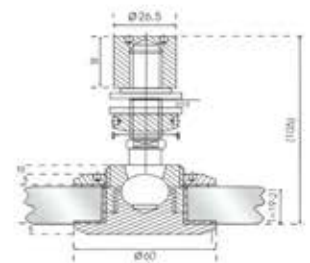

**KSP-AFB-CS**  
Articulated Routel  
with Counter Sunk Hole

- Specification**
- Countersunk head routel to be used along with spiders to hold glass
  - Material : Stainless Steel 304 Grade
  - With teflon washers to prevent glass from damage

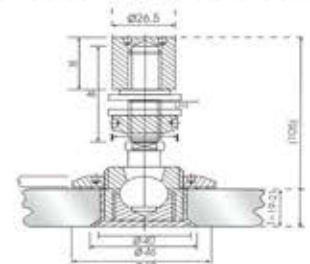
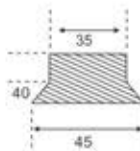

**KSP-FB-FH**  
Fix Routel  
(Flat Head)

- Specification**
- Articulated Cunter Sunk routel to be used along with spiders to hole glass
  - Material : Stainless Steel 304 Grade
  - With teflon washers to prevent glass from damage
  - Adjustable upto 15mm glass thickness

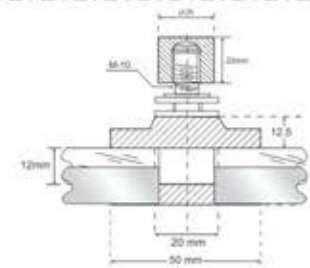

**KSP-FB-CS**  
Fix Routel  
with Counter Sunk Hole

- Specification**
- Fixed flat head routel to be used along with spiders to hold glass
  - Material : Stainless Steel 304 Grade
  - With teflon washers to prevent glass from damage
  - Adjustable to glass thickness
  - Smaller in sizes

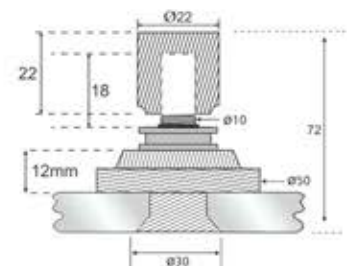
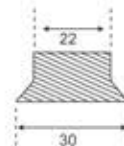

**KSP-SH-01**  
Iron Assembly

- Specification**
- Fixing bolt helps to hold without fin spiders with fix structure
  - Material : Stainless Steel 304 Grade
  - Adjustable height for accurate fixing of spider with flat head

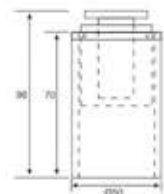



# SPIDER FITTINGS



## Fin Plates



**KSP-FP-200**  
Fin Plate 200mm

**Specification**

- Single point holding of fin
- Finish : Satin Stainless Steel (SSS)
- Material : Stainless Steel 304 Grade
- With teflon washers to prevent glass from damage

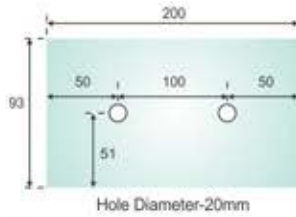

## Splice Plates



**KSP-SP-200**  
Splice Plate 200mm

**Specification**

- Two point holding with each fin part
- Finish : Satin Stainless Steel (SSS)
- Material : Stainless Steel 304 Grade
- With teflon washers to prevent glass from damage

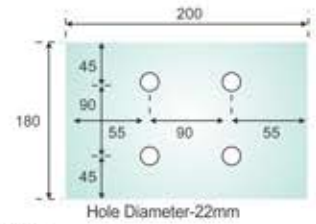

**KSP-FP-250**  
Fin Plate 250mm

**Specification**

- Two point holding of fin
- Finish : Satin Stainless Steel (SSS)
- Material : Stainless Steel 304 Grade
- With teflon washers to prevent glass from damage

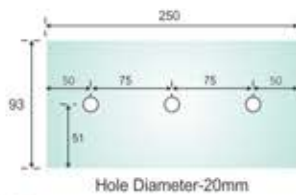

**KSP-SP-250**  
Splice Plate 250mm

**Specification**

- Three point holding with each fin part
- Finish : Satin Stainless Steel (SSS)
- Material : Stainless Steel 304 Grade
- With teflon washers to prevent glass from damage

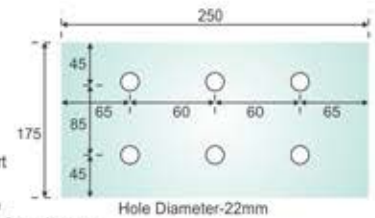

**KSP-FP-300**  
Fin Plate 300mm

**Specification**

- Three point holding of fin
- Finish : Satin Stainless Steel (SSS)
- Material : Stainless Steel 304 Grade
- With teflon washers to prevent glass from damage

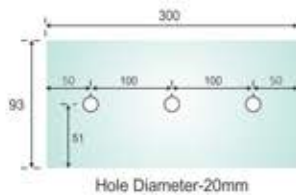

**KSP-SP-300**  
Splice Plate 300mm

**Specification**

- Three point holding with each fin part
- Finish : Satin Stainless Steel (SSS)
- Material : Stainless Steel 304 Grade
- With teflon washers to prevent glass from damage

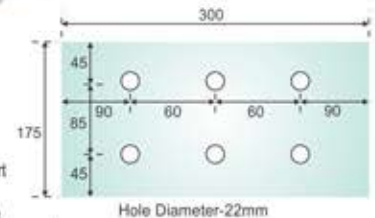

**KSP-FP-350/400**  
Fin Plate 350/400mm

**Specification**

- Three point holding of fin
- Finish : Satin Stainless Steel (SSS)
- Material : Stainless Steel 304 Grade
- With teflon washers to prevent glass from damage

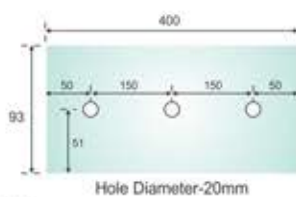
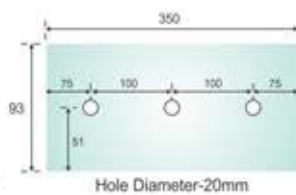

**KSP-SP-350**  
Splice Plate 350mm

**Specification**

- Three point holding with each fin part
- Finish : Satin Stainless Steel (SSS)
- Material : Stainless Steel 304 Grade
- With teflon washers to prevent glass from damage

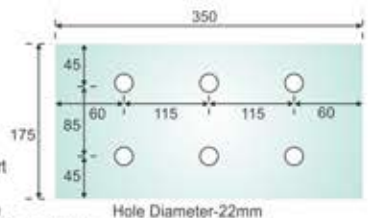

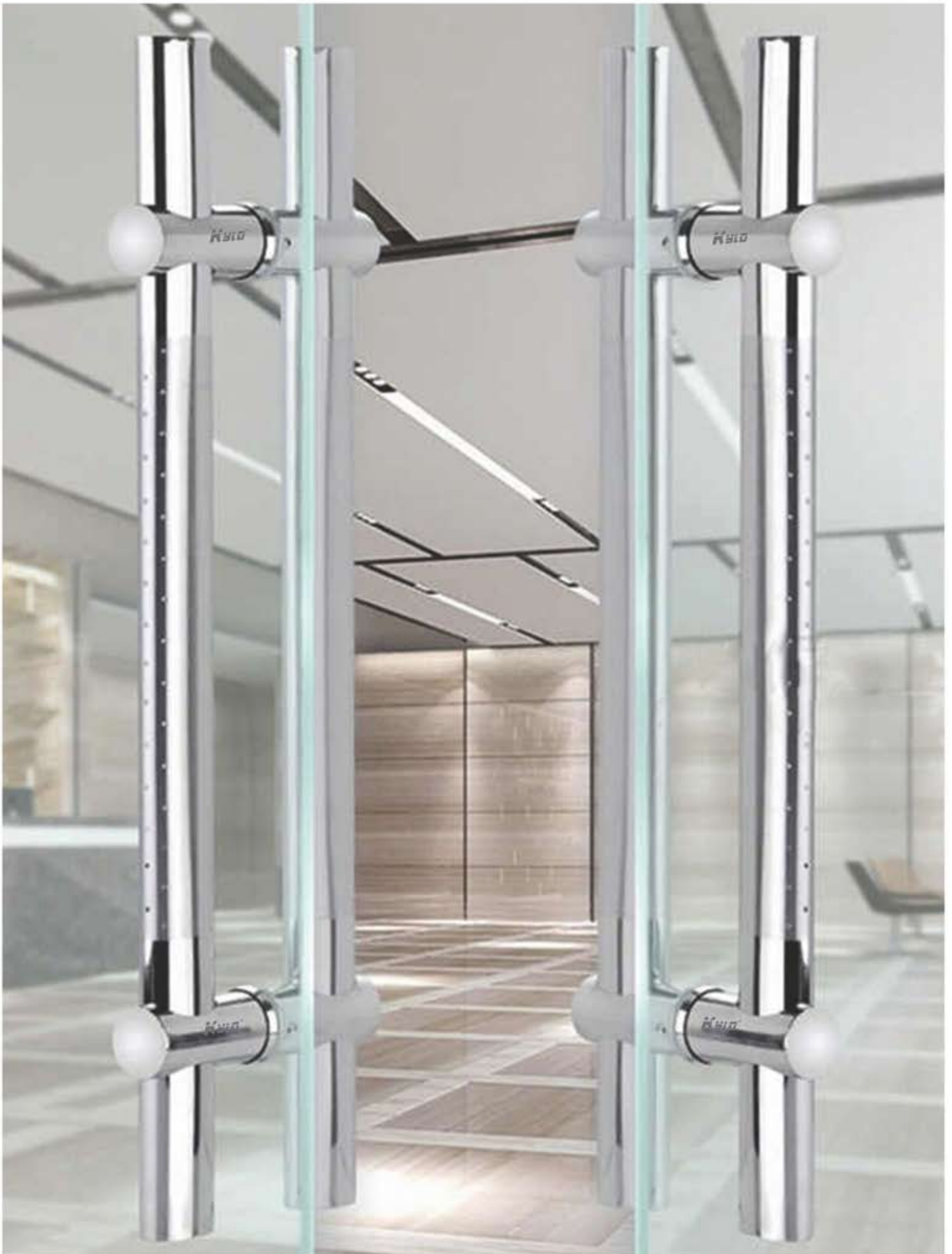

# DOOR HANDLES

Door Handles Also Available in Premium Series

### Specification

- Finish : Satin + Polish stainless steel / Full Satin
- Material : Stainless steel
- For back to back installation
- With gasket to prevent glass from damage
- With grub screw to give neat look
- All sizes in mm

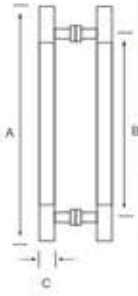

**KGDH-55**

Overall Length (A)	Centre to Centre Hole (B)	Diameter (C)
300	200	25
350	253	25
400	300	25
457	305	32
600	450	32
600	480	32
900	600	32
1200	900	32

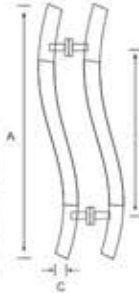

**KGDH-22**

Overall Length (A)	Centre to Centre Hole (B)	Diameter (C)
300	250	25
457	305	25

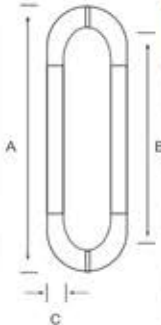

**KGDH-11**

Overall Length (A)	Centre to Centre Hole (B)	Diameter (C)
200		25
250		25
300		25
457		25

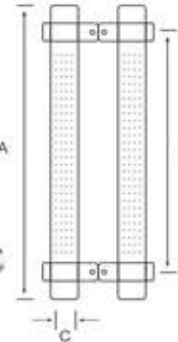

**KGDH-44**

Overall Length (A)	Centre to Centre Hole (B)	Diameter (C)
457	305	25
600	450	25

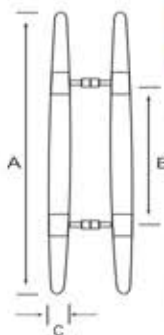

**KGDH-1052**

Overall Length (A)	Centre to Centre Hole (B)	Diameter (C)
600	400	32

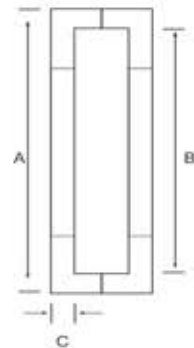

**KGDH-1030**

Overall Length (A)	Centre to Centre Hole (B)	Diameter (C)
325	305	30
480	450	30



**KGDH-1068**

Overall Length (A)	Centre to Centre Hole (B)	Diameter (C)
330	305	25
285	253	32



**KGDH-2050**

Overall Length (A)	Centre to Centre Hole (B)	Diameter (C)
457	305	38
600	450	38

Door Handles Also Available in Premium Series

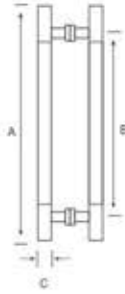

**KGDH-55-B**

Overall Length (A)	Centre to Centre Hole (B)	Diameter (C)
457	305	32



**KGDH-1007**

Overall Length (A)	Centre to Centre Hole (B)	Diameter (C)
457	305	25/38

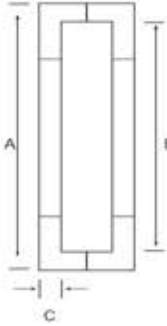

**KGDH-1031**

Overall Length (A)	Centre to Centre Hole (B)	Diameter (C)
325	305	30
475	450	30



**KGDH-1032**

Overall Length (A)	Centre to Centre Hole (B)	Diameter (C)
457	305	32

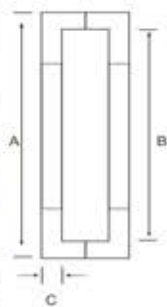

**KGDH-1017 (Black Mirror Finish)**

Overall Length (A)	Centre to Centre Hole (B)	Diameter (C)
325	305	30
480	450	30



**KGDH-3003**

Overall Length (A)	Centre to Centre Hole (B)	Diameter (C)
800	450	35

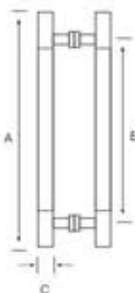

**KGDH-2050 (PSS & SSS)**

Overall Length (A)	Centre to Centre Hole (B)	Diameter (C)
450	305	25x45
600	450	25x45

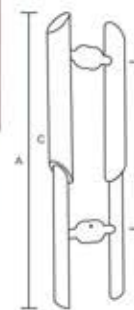

**KGDH-1105**

Overall Length (A)	Centre to Centre Hole (B)	Diameter (C)
450	305	38x25

# DOOR HANDLES

Door Handles Also Available in Premium Series

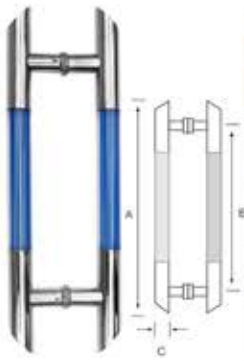

**KGDH-1123 (PSS + Crystal)**

Overall Length (A)	Centre to Centre Hole (B)	Diameter (C)
457	305	38



**KGDH-1120 (PSS + Crystal)**

Overall Length (A)	Centre to Centre Hole (B)	Diameter (C)
450	305	38



**KGDH-1017 (PSS& Wood)**

Overall Length (A)	Centre to Centre Hole (B)	Diameter (C)
457	305	38
600	450	39



**KGDH-2050 (Black Mirror)**

Overall Length (A)	Centre to Centre Hole (B)	Diameter (C)
450	305	25x45
600	450	25x45



## Shower Handles



**KGH-TB-01**

Overall Length (A)	Centre to Centre Hole (B)	Diameter of Handle (C)
457SSS	152	19
457PSS	152	19

- Specification**
- Material : Stainless steel
  - For back to back installation
  - With gasket to prevent glass from damage
  - With grub screw to give neat look
  - All sizes in mm



**KGH-TB-02**

Overall Length (A)	Centre to Centre Hole (B)	Diameter of Handle (C)
457SSS	152	15/30
457PSS	152	15/30

- Specification**
- Material : Stainless steel
  - For back to back installation
  - With gasket to prevent glass from damage
  - With grub screw to give neat look
  - All sizes in mm



**KLK-1**  
Double Door Lock (Only Key)

- Specification**
- Material : Stainless steel
  - Finish : Satin stainless steel
  - One side key-Lock from outside only
  - Suitable for 10/12mm Glass
  - Glass preparation/cutout not required
  - With gasket to prevent glass from damage
  - With three bass computer key
  - Suitable for glass to glass



**KLK-2**  
Single Door Lock (Only Key)

- Specification**
- Material : Stainless steel
  - Finish : Satin stainless steel
  - One side key-Lock from outside only
  - Suitable for 10/12mm Glass
  - Glass preparation/cutout not required
  - With gasket to prevent glass from damage
  - With three bass computer key
  - Suitable for glass to wall/fix structure



**KLK-3**  
Double Door Lock (Key & Knob)

- Specification**
- Material : Stainless steel
  - Finish : Satin stainless steel
  - One side key-Lock from outside only
  - Suitable for 10/12mm Glass
  - Glass preparation/cutout not required
  - With gasket to prevent glass from damage
  - With three bass computer key
  - Suitable for glass to glass



**KLK-4**  
Single Door Lock (Key & Knob)

- Specification**
- Material : Stainless steel
  - Finish : Satin stainless steel
  - One side key-Lock from outside only
  - Suitable for 10/12mm Glass
  - Glass preparation/cutout not required
  - With gasket to prevent glass from damage
  - With three bass computer key
  - Suitable for glass to wall/fix structure



**KLK-5**  
Double Door Lock (Key & Knob)

- Specification**
- Material : Stainless steel
  - Finish : Satin stainless steel
  - One side key-Lock from outside only
  - Suitable for 10/12mm Glass
  - Glass preparation/cutout not required
  - With gasket to prevent glass from damage
  - With three bass computer key
  - Suitable for glass to glass



**KLK-6**  
Single Door Lock (Key & Knob)

- Specification**
- Material : Stainless steel
  - Finish : Satin stainless steel
  - One side key-Lock from outside only
  - Suitable for 10/12mm Glass
  - Glass preparation/cutout not required
  - With gasket to prevent glass from damage
  - With three bass computer key
  - Suitable for glass to wall/fix structure



**KLK-7**  
Double Door Lock (Only Knob)

- Specification**
- Material : Stainless steel
  - Finish : Satin stainless steel
  - One side knob only
  - Suitable for 10/12mm Glass
  - Glass preparation/cutout not required
  - With gasket to prevent glass from damage
  - With three bass computer key
  - Suitable for glass to glass



**KLK-8**  
Double Door Lock (Only Knob)

- Specification**
- Material : Stainless steel
  - Finish : Satin stainless steel
  - One side knob only
  - Suitable for 10/12mm Glass
  - Glass preparation/cutout not required
  - With gasket to prevent glass from damage
  - With three bass computer key
  - Suitable for glass to glass



**SLK-9**  
Double Door Lock (Only Knob)

- Specification**
- Material : Stainless steel
  - Finish : Satin stainless steel
  - One side knob only
  - Suitable for 10/12mm Glass
  - Glass preparation/cutout not required
  - With gasket to prevent glass from damage
  - With three bass computer key
  - Suitable for glass to glass



**SLK-10**  
Single Door Lock (Only Knob)

- Specification**
- Material : Stainless steel
  - Finish : Satin stainless steel
  - One side knob only
  - Suitable for 10/12mm Glass
  - Glass preparation/cutout not required
  - With gasket to prevent glass from damage
  - With three bass computer key
  - Suitable for glass to wall/fix structure



**SLK-11**  
Double Door Lock (Only Knob)

- Specification**
- Material : Stainless steel
  - Finish : Satin stainless steel
  - One knob only
  - Suitable for 10/12mm Glass
  - Glass preparation/cutout not required
  - With gasket to prevent glass from damage
  - With three bass computer key
  - Suitable for glass to glass



**SLK-12**  
Single Door Lock (Only Knob)

- Specification**
- Material : Stainless steel
  - Finish : Satin stainless steel
  - One side knob only
  - Suitable for 10/12mm Glass
  - Glass preparation/cutout not required
  - With gasket to prevent glass from damage
  - With three bass computer key
  - Suitable for glass to wall/fix structure

# DOOR CLOSER



**KDC-100**  
Door Closer (Eco)  
Door Weight Capacity : 40-45 kg

- Specification**
- Applicable door width : 500-1000mm
  - Applicable door weight upto **40-45kg**
  - Adjustable section of closing speed 180°-20°
  - Adjustable section of latching speed 20°-0°
  - The door closer is suitable for installing in various doors, such as wooden door, metal door, etc
  - The door closer can be chosen to stop or unstop at will
  - Continuous adjustment of closing and latching speed: the fast speed can be adjusted to within 3 seconds from 90 degree, slowness close can reach to 60 seconds or more



**KDC-102**  
Door Closer (Classic)  
Door Weight Capacity : 60-65 kg

- Specification**
- Applicable door width : 600-1200mm
  - Applicable door weight upto **60-65kg**
  - Adjustable section of closing speed 180°-20°
  - Adjustable section of latching speed 20°-0°
  - The door closer is suitable for installing in various doors, such as wooden door, metal door, etc
  - The door closer can be chosen to stop or unstop at will
  - Continuous adjustment of closing and latching speed: the fast speed can be adjusted to within 3 seconds from 90 degree, slowness close can reach to 60 seconds or more

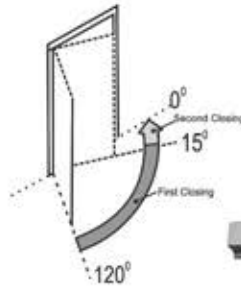

**KDC-101**  
Door Closer (Sleek)  
Door Weight Capacity : 40-65 kg

- Specification**
- Applicable door width : 800-1100mm
  - Applicable door weight upto **40-65kg**
  - Adjustable section of closing speed 180°-20°
  - Adjustable section of latching speed 20°-0°
  - The door closer is suitable for installing in various doors, such as wooden door, metal door, etc
  - The door closer can be chosen to stop or unstop at will
  - Continuous adjustment of closing and latching speed: the fast speed can be adjusted to within 3 seconds from 90 degree, slowness close can reach to 60 seconds or more



**KCDC-01**  
Door Closer (Concealed)  
Door Weight Capacity : 30-65 kg

- Specification**
- Applicable door width : 500-1200mm
  - Applicable door weight upto **30-65kg**
  - With pelmet arm for hold open function
  - Fit into inside wooden, metal doors.
  - Adjustable section of closing speed 180°-20°
  - Adjustable section of latching speed 20°-0°
  - The door closer is suitable for installing in various doors, such as wooden door, metal door, etc
  - The installation modes of vertical, parallel and slide-rail type all can be chosen at will
  - Continuous adjustment of closing and latching speed: the fast speed can be adjusted to within 3 seconds from 90 degree, slowness close can reach to 60 seconds or more

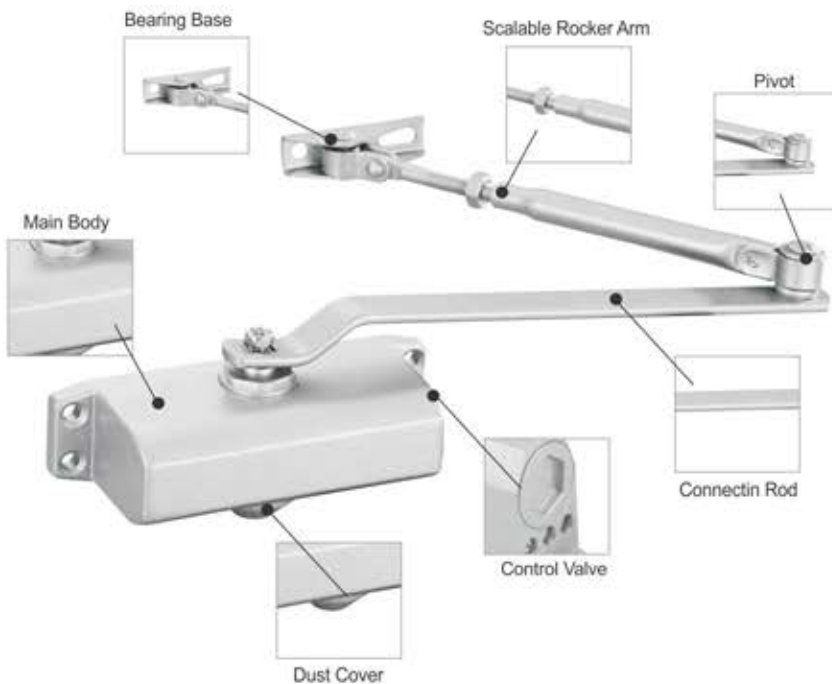

## Application and Fixing

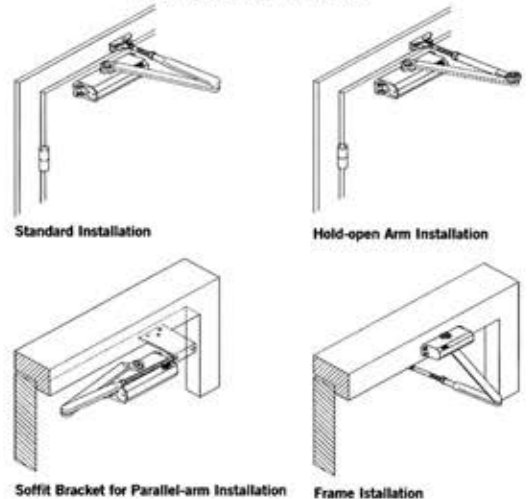



**KGP-22**  
Glazing Profile

Specification  
Material : Aluminium  
For 10 to 12 mm Glass  
Size : 10 FL.

Available Colours : Aluminium and Champagne

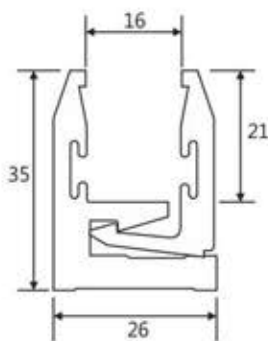

## Bracket Shelf Holders



**KBSH-01**  
Double Shelf Holder  
(10-12 mm)



**KBSH-02**  
Single Shelf Holder  
(10-12 mm)



**KMH-01 (SS 304)**  
Wall to Glass Hinge



**KMH-02 (Curve)**  
Wall to Glass Hinge



**KMH-03 (SS 304)**  
Glass to Glass Hinge

## Mini Hinges (For 5mm-10mm Glass)

## GLASS LIFTER (Silicon Cup)



**KGL-1C**  
Glass Lifter with Single Cup



**KGL-2C**  
Glass Lifter with Two Cup



**KGL-3C**  
Glass Lifter with Three Cup





# GLASS RAILING ACCESSORIES



**KRA-1**  
Spigot 9"

**Specification**

- Solid Stainless Steel 304 Grade
- Suitable for 10-15mm Glass
- With Teflon Gasket to Prevent Glass From Damage
- No needs to be grouted inside the Floor Level
- No Holes required in the Glass
- Also Can be used with accessories
- Finish : SSS/ CP



**KRA-1A**  
Spigot 6"



**KRA-1B**  
Spigot 4"

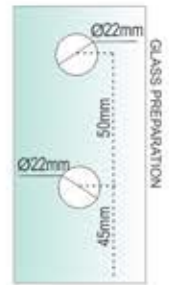

**KRA-2**  
Spigot 9"

**Specification**

- Solid Stainless Steel 304 Grade
- Suitable for 10-15mm Glass
- With Teflon Gasket to Prevent Glass From Damage
- No needs to be grouted inside the Floor Level
- No Holes required in the Glass
- Also Can be used with accessories
- Finish : SSS/ CP



**KRA-2A**  
Spigot 9"



**KRA-2B**  
Spigot 9"



**KRA-4**  
Glass to Hand Rail



**KRA-5**  
Wall to Hand Rail

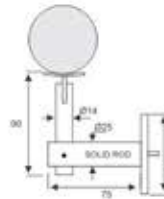

**KRA-6**  
Glass to Hand Rail

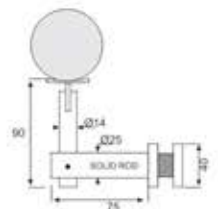



**KRA-7 (Flat Back)**  
U Shape Railing Connector



**KRA-8 (Curve Back)**  
U Shape Railing Connector



**KRA-9**  
Railing Stud & Fastener

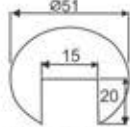

**KRA-10**  
Single Slotted Round Pipe

**Specification**  
• Available in 6mtr. Length  
• Slot Size 15mmx15mm  
20mmx20mm

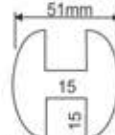

**KRA-11**  
Double Slotted Round Pipe

**Specification**  
• Available in 6mtr. Length  
• Slot Size 15mmx15mm  
20mmx20mm



**KRA-120**  
Single Slotted Curve Pipe

**Specification**  
• Available in 6mtr. Length  
• Slot Size 15mmx15mm  
20mmx20mm

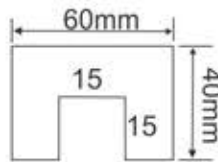

**KRA-13**  
Single Slotted Square Pipe

**Specification**  
• Available in 6mtr. Length  
• Slot Size 15mmx15mm  
20mmx20mm



**KRA-14**  
Slotted Pipe Joints 180°



**KRA-15**  
Slotted Pipe Joints 90°



**KRA-16**  
Slotted Pipe Joints L Type 180°



**KRA-17**  
Straight Joints



**KRA-18**  
Wall to Slotted Pipe Joints



**KRA-19**  
Slotted Pipe End Caps



**KRA-24**  
Slotted Pipe Joints 180°



**KRA-25**  
Slotted Pipe Joints 90°



**KRA-26**  
Slotted Pipe Joints L Type 180°



**KRA-27**  
Straight Joints



**KRA-28**  
Wall to Slotted Pipe Joints



**KRA-29**  
Slotted Pipe End Caps



**Premium colours  
(Rose Gold, Silver, Black and Gold) are available  
in Glass Railing Accessories.**





ARCHITECTURAL HARDWARE

E- Mail: [info@kylohardware.com](mailto:info@kylohardware.com)

Website: [www.kylohardware.com](http://www.kylohardware.com)

